

MSX440

规格
Size $\phi 3 \times R0.2 \sim \phi 20 \times R1$



无限涂层 强力重切削用4刃圆鼻铣刀

MUGEN COATING Power Corner Radius End Mill

共有16种规格

Total 16 sizes

不等分割和不等螺旋角可将振刀现象抑制到最小
从钢材到不锈钢皆可应对。

Unequal helix angle and flute spacing to minimize chattering
Suitable for steels to stainless steels

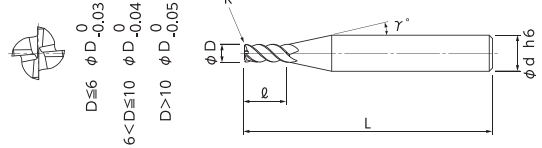
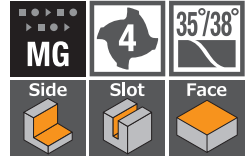

- 采用不等螺旋角，可对应不锈钢、难削材料的粗加工。
- 有助于缩短粗加工时间。
- It is very suitable for roughing and semi-finishing on stainless steels and tough materials by unequal flute design.
- High performance for reducing roughing time.

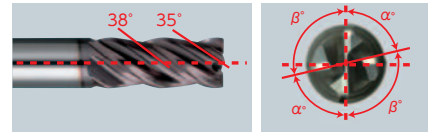

不等螺旋角
Unequal Helix Angle

不等分割
Unequal Flute Spacing



▲ 停产产品 Discontinued Products
★ 返修对应 (柄长须在15mm以上。详情请咨询本公司。)

单位 [规格: mm / 价格: 日元]
Unit [Size: mm / Retail Price: JPY]

产品代码 Code No.	(D)外径 Dia.	(ℓ)刃长 Length of Cut	(R)角半径 Corner Radius	(γ)颈角 Neck Taper Angle	(d)柄径 Shank Dia.	(L)全长 Overall Length	定价(日元) Retail Price
★ 08-00144-00300	3	8	R0.2	12°	6	55	6,800
★ 08-00144-00400	4	11	R0.2	12°	6	55	7,200
★ 08-00144-00500	5	13	R0.2	12°	6	55	7,800
★ 08-00144-00600	6	13	R0.3	—	6	55	7,900
★ 08-00144-00700	7	19	R0.3	12°	8	60	11,400
★ 08-00144-00800	8	19	R0.3	—	8	60	11,400
★ 08-00144-00900	9	22	R0.3	12°	10	70	13,300
★ 08-00144-01000	10	22	R0.3	—	10	70	13,300
★ 08-00144-01100	11	26	R0.3	12°	12	80	21,800
★ 08-00144-01200	12	26	R0.3	—	12	80	19,700
▲ 08-00144-01300	13	26	R0.7	12°	16	90	35,700
▲ 08-00144-01400	14	26	R0.7	12°	16	90	35,700
▲ 08-00144-01500	15	32	R1	12°	16	90	35,700
▲ 08-00144-01600	16	32	R1	—	16	90	35,700
▲ 08-00144-01800	18	32	R1	12°	20	105	59,900
▲ 08-00144-02000	20	38	R1	—	20	105	58,700

订购方法 How to Order 请指定MSX440 外径(D)。 ※(γ)为参考值。
When you order, indicate MSX440 (D). ※(γ) is reference value.

▲ 符号表示停产产品。在库存售完之后将不再贩卖。
▲ Discontinued products. The marked sizes will no longer be on sale after the stock runs out.

高效率加工
High Efficient
Milling