

无限涂层 长颈锥形球头铣刀

共有196种规格  
Total 196 sizes

MUGEN COATING 2-Flute Long Taper Neck Ball End Mill

采用锥形形状，大幅提高刀具刚性！L/D最大36倍  
可使用与加工面倾斜角角度相同的颈角

Taper neck to improve tool rigidity. L/D up to 36.  
Option of same taper angle as inclined working angle

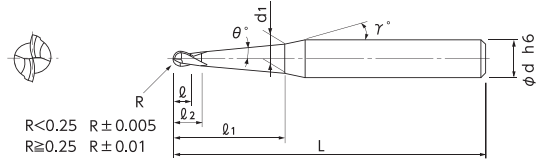

- 颈部为锥形设计，提高了刀具刚性。
- 与传统产品相比，可设定较大的切深量。
- It is possible to increase rigidity with the neck taper.
- The volume of depth of cut will be more than conventional end mills.

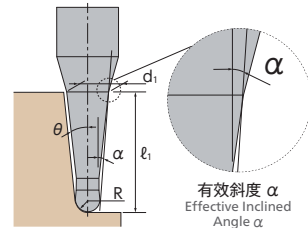

★ 返修对应 (柄长须在15mm以上。详情请咨询本公司。)

单位 [规格: mm / 价格: 日元]  
Unit [Size : mm / Retail Price : JPY]

产品代码 Code No.	(R)球头半径 Radius	( $\theta$ )颈角 Neck Taper Angle	( $l_1$ )颈长 Under Neck Length	( $d_1$ )颈径 Neck Dia.	( $l$ )刀长 Length of Cut	( $l_2$ )颈长2 Under Neck Length 2	( $\gamma$ )颈角2 Neck Taper Angle 2	( $\alpha$ )有效斜度 Effective Inclined Angle	(d)柄径 Shank Dia.	(L)全长 Overall Length	定价(日元) Retail Price	
08-00570-01020	R0.1	30'	1	0.21	0.2	0.4	12°	0°19'	4	50	9,500	
08-00570-01021			1.5	0.22	0.2	0.4	12°	0°23'	4	50	10,100	
08-00570-01022			2	0.23	0.2	0.4	12°	0°25'	4	50	10,600	
08-00570-01040		1°	1	0.22	0.2	0.4	12°	0°38'	4	50	9,500	
08-00570-01041			1.5	0.24	0.2	0.4	12°	0°47'	4	50	10,100	
08-00570-01042			2	0.26	0.2	0.4	12°	0°51'	4	50	10,600	
08-00570-01050		1°30'	1	0.23	0.2	0.4	12°	0°57'	4	50	9,500	
08-00570-01051			1.5	0.26	0.2	0.4	12°	1°11'	4	50	10,100	
08-00570-01052			2	0.28	0.2	0.4	12°	1°16'	4	50	10,600	
08-00570-01060		2°	1	0.24	0.2	0.4	12°	1°16'	4	50	9,500	
08-00570-01061			1.5	0.28	0.2	0.4	12°	1°35'	4	50	10,100	
08-00570-01062			2	0.31	0.2	0.4	12°	1°41'	4	50	10,600	
08-00570-01080		3°	1	0.26	0.2	0.4	12°	1°54'	4	50	9,500	
08-00570-01081			1.5	0.32	0.2	0.4	12°	2°21'	4	50	10,100	
08-00570-01082			2	0.37	0.2	0.4	12°	2°32'	4	50	10,600	
08-00570-01092		5°	2	0.48	0.2	0.4	12°	4°13'	4	50	10,600	
08-00570-01521		R0.15	30'	3	0.34	0.3	0.6	12°	0°25'	4	50	10,600
08-00570-01540			1°	2	0.35	0.3	0.6	12°	0°45'	4	50	10,100
08-00570-01541	3			0.38	0.3	0.6	12°	0°51'	4	50	10,600	
08-00570-01550	1°30'		2	0.37	0.3	0.6	12°	1°08'	4	50	10,100	
08-00570-01551			3	0.43	0.3	0.6	12°	1°16'	4	50	10,600	
08-00570-01561	2°		3	0.47	0.3	0.6	12°	1°41'	4	50	10,600	
08-00570-01581	3°		3	0.55	0.3	0.6	12°	2°32'	4	50	10,600	
08-00570-01591	5°	3	0.72	0.3	0.6	12°	4°13'	4	50	10,600		
08-00570-02021	R0.2	30'	2	0.42	0.4	0.8	12°	0°20'	4	50	7,800	
08-00570-02023			3	0.44	0.4	0.8	12°	0°24'	4	50	7,800	
08-00570-02022			4	0.46	0.4	0.8	12°	0°25'	4	50	7,800	
08-00570-02041		1°	2	0.44	0.4	0.8	12°	0°40'	4	50	7,800	
08-00570-02043			3	0.48	0.4	0.8	12°	0°47'	4	50	7,800	
08-00570-02042			4	0.51	0.4	0.8	12°	0°51'	4	50	7,800	

订购方法  
How to Order

请指定MRBTN230 球头半径(R)×颈角( $\theta$ )×颈长( $l_1$ )。  
When you order, indicate MRBTN230 (R)×( $\theta$ )×( $l_1$ ).

※( $\gamma$ )为参考值。  
※( $\gamma$ ) is reference value.

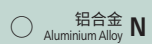

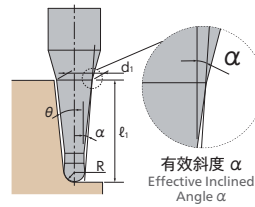

★ 返修对应 (柄长须在15mm以上。详情请咨询本公司。)

单位 [规格:mm / 价格:日元]  
Unit [Size : mm / Retail Price : JPY]

产品代码 Code No.	(R)球头半径 Radius	(θ)颈角 Neck Taper Angle	(ℓ <sub>1</sub> )颈长 Under Neck Length	(d <sub>1</sub> )颈径 Neck Dia.	(ℓ)刃长 Length of Cut	(ℓ <sub>2</sub> )颈长2 Under Neck Length 2	(γ)颈角2 Neck Taper Angle 2	(α)有效斜度 Effective Inclined Angle	(d)柄径 Shank Dia.	(L)全长 Overall Length	定价(日元) Retail Price
08-00570-02051	R0.2	1°30'	2	0.46	0.4	0.8	12°	1°00'	4	50	7,800
08-00570-02053			3	0.52	0.4	0.8	12°	1°11'	4	50	7,800
08-00570-02052			4	0.57	0.4	0.8	12°	1°16'	4	50	7,800
08-00570-02061		2°	2	0.48	0.4	0.8	12°	1°20'	4	50	7,800
08-00570-02063			3	0.55	0.4	0.8	12°	1°34'	4	50	7,800
08-00570-02062			4	0.62	0.4	0.8	12°	1°41'	4	50	7,800
08-00570-02081			2	0.53	0.4	0.8	12°	2°00'	4	50	7,800
08-00570-02082		4	0.74	0.4	0.8	12°	2°31'	4	50	7,800	
08-00570-02092		5°	4	0.96	0.4	0.8	12°	4°13'	4	50	7,800
08-00570-02521		R0.25	30'	3	0.53	0.5	1	12°	0°22'	4	50
08-00570-02522	5			0.57	0.5	1	12°	0°25'	4	50	7,600
08-00570-02541	1°		3	0.57	0.5	1	12°	0°44'	4	50	7,400
08-00570-02542			5	0.64	0.5	1	12°	0°51'	4	50	7,600
08-00570-02551	1°30'		3	0.6	0.5	1	12°	1°06'	4	50	7,400
08-00570-02552			5	0.71	0.5	1	12°	1°16'	4	50	7,600
08-00570-02561			3	0.64	0.5	1	12°	1°27'	4	50	7,400
08-00570-02562	5		0.78	0.5	1	12°	1°41'	4	50	7,600	
08-00570-02581	3°		3	0.71	0.5	1	12°	2°11'	4	50	7,400
08-00570-02582			5	0.92	0.5	1	12°	2°32'	4	50	7,600
08-00570-02592		5	1.2	0.5	1	12°	4°13'	4	50	7,600	
08-00570-03021	R0.3	30'	5	0.67	0.6	1.2	12°	0°24'	4	50	7,200
08-00570-03022			8	0.72	0.6	1.2	12°	0°27'	4	50	7,500
08-00570-03040		1°	4	0.7	0.6	1.2	12°	0°45'	4	50	6,900
08-00570-03041			5	0.73	0.6	1.2	12°	0°49'	4	50	7,200
08-00570-03043			6	0.77	0.6	1.2	12°	0°51'	4	50	7,200
08-00570-03042			8	0.84	0.6	1.2	12°	0°53'	4	50	7,500
08-00570-03051		1°30'	5	0.8	0.6	1.2	12°	1°13'	4	50	7,200
08-00570-03052			8	0.96	0.6	1.2	12°	1°19'	4	50	7,500
08-00570-03061		2°	6	0.94	0.6	1.2	12°	1°41'	4	50	7,200
08-00570-03062			8	1.07	0.6	1.2	12°	1°46'	4	50	7,500
08-00570-03081	3°	6	1.1	0.6	1.2	12°	2°32'	4	50	7,200	
08-00570-03082		8	1.31	0.6	1.2	12°	2°39'	4	50	7,500	
08-00570-03092	5°	8	1.79	0.6	1.2	12°	4°25'	4	50	7,500	
08-00570-04021	R0.4	30'	8	0.91	0.8	1.6	12°	0°25'	4	50	7,800
08-00570-04022			12	0.98	0.8	1.6	12°	0°27'	4	60	8,200
08-00570-04041		1°	8	1.02	0.8	1.6	12°	0°50'	4	50	7,800
08-00570-04042			12	1.16	0.8	1.6	12°	0°54'	4	60	8,200
08-00570-04051		1°30'	8	1.14	0.8	1.6	12°	1°16'	4	50	7,800
08-00570-04052			12	1.34	0.8	1.6	12°	1°21'	4	60	8,200
08-00570-04061		2°	8	1.25	0.8	1.6	12°	1°42'	4	50	7,800
08-00570-04062			12	1.53	0.8	1.6	12°	1°48'	4	60	8,200

锥颈  
Taper Neck  
球头  
Ball  
涂层  
CoatingP 碳素钢  
Carbon SteelP 合金钢  
Alloy SteelP 调质钢  
Prehardened SteelH ~52高硬度钢  
HRC Hardened SteelM 不锈钢  
Stainless SteelN 铝合金  
Aluminium AlloyN 铜合金  
CopperO 树脂  
Resin常规系列  
无限涂层  
长颈造型  
Regular Line  
MUGEN COATING  
Long Neck Type

# MRBTN230

## 无限涂层 长颈锥形球头铣刀

MUGEN COATING 2-Flute Long Taper Neck Ball End Mill

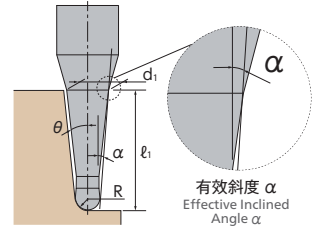

★ 返修对应 (柄长须在15mm以上。详情请咨询本公司。)

单位 [规格:mm / 价格:日元]  
Unit [Size : mm / Retail Price : JPY]

产品代码 Code No.	(R)球头半径 Radius	(θ)颈角 Neck Taper Angle	(l1)颈长 Under Neck Length	(d1)颈径 Neck Dia.	(l)刃长 Length of Cut	(l2)颈长2 Under Neck Length 2	(γ)颈角2 Neck Taper Angle 2	(α)有效斜度 Effective Inclined Angle	(d)柄径 Shank Dia.	(L)全长 Overall Length	定价(日元) Retail Price	
08-00570-04081	R0.4	3°	8	1.47	0.8	1.6	12°	2°31′	4	50	7,800	
08-00570-04082			12	1.89	0.8	1.6	12°	2°41′	4	60	8,200	
★ 08-00570-05021	R0.5	30′	10	1.14	1	2	12°	0°25′	4	60	6,600	
★ 08-00570-05022			15	1.23	1	2	12°	0°27′	4	60	6,900	
★ 08-00570-05023			20	1.31	1	2	12°	0°28′	4	70	8,400	
★ 08-00570-05024			25	1.41	1	2	12°	0°29′	4	70	8,900	
★ 08-00570-05039			6	1.14	1	2	12°	0°43′	4	60	5,500	
★ 08-00570-05040			8	1.21	1	2	12°	0°48′	4	60	6,000	
★ 08-00570-05041		1°	10	1.28	1	2	12°	0°50′	4	60	6,600	
★ 08-00570-05044			12	1.35	1	2	12°	0°52′	4	60	6,600	
★ 08-00570-05042			15	1.45	1	2	12°	0°54′	4	60	6,900	
★ 08-00570-05045			16	1.49	1	2	12°	0°54′	4	60	6,900	
★ 08-00570-05043			20	1.63	1	2	12°	0°55′	4	70	8,400	
★ 08-00570-05046			22	1.7	1	2	12°	0°56′	4	70	8,600	
★ 08-00570-05047			25	1.8	1	2	12°	0°56′	4	70	8,900	
★ 08-00570-05049			1°30′	6	1.21	1	2	12°	1°05′	4	60	5,500
★ 08-00570-05050				8	1.31	1	2	12°	1°12′	4	60	6,000
★ 08-00570-05051				10	1.42	1	2	12°	1°16′	4	60	6,600
★ 08-00570-05054				12	1.52	1	2	12°	1°18′	4	60	6,600
★ 08-00570-05052				15	1.68	1	2	12°	1°21′	4	60	6,900
★ 08-00570-05055	16	1.73		1	2	12°	1°21′	4	60	6,900		
★ 08-00570-05053	20	1.94		1	2	12°	1°23′	4	70	8,400		
★ 08-00570-05056	22	2.05		1	2	12°	1°24′	4	70	8,600		
★ 08-00570-05057	25	2.2		1	2	12°	1°24′	4	70	8,900		
★ 08-00570-05059	36	2.78		1	2	12°	1°26′	4	70	9,800		
★ 08-00570-05061	2°	10	1.56	1	2	12°	1°41′	4	60	6,600		
★ 08-00570-05062		15	1.91	1	2	12°	1°48′	4	60	6,900		
★ 08-00570-05063		20	2.26	1	2	12°	1°51′	4	70	8,400		
★ 08-00570-05081	3°	10	1.84	1	2	12°	2°31′	4	60	6,600		
★ 08-00570-05082		15	2.36	1	2	12°	2°41′	4	60	6,900		
★ 08-00570-05083		20	2.89	1	2	12°	2°46′	4	70	8,400		
★ 08-00570-05092	5°	15	3.27	1	2	12°	4°28′	6	60	9,400		
★ 08-00570-05093		20	4.15	1	2	12°	4°37′	6	70	10,700		
★ 08-00570-06021	R0.6	30′	12	1.37	1.2	2.4	12°	0°25′	4	60	7,600	
★ 08-00570-06022			24	1.58	1.2	2.4	12°	0°28′	4	70	9,300	
★ 08-00570-06041		1°	12	1.54	1.2	2.4	12°	0°51′	4	60	7,600	
★ 08-00570-06042			24	1.95	1.2	2.4	12°	0°55′	4	70	9,300	
★ 08-00570-06051			1°30′	12	1.7	1.2	2.4	12°	1°16′	4	60	7,600
★ 08-00570-06052				24	2.33	1.2	2.4	12°	1°23′	4	70	9,300
★ 08-00570-06061		2°	12	1.87	1.2	2.4	12°	1°41′	4	60	7,600	
★ 08-00570-06062			24	2.71	1.2	2.4	12°	1°51′	4	70	9,300	

订购方法  
How to Order

请指定MRBTN230 球头半径(R)×颈角(θ)×颈长(l1)。 ※(γ)为参考值。  
When you order, indicate MRBTN230 (R)×(θ)×(l1). ※(γ) is reference value.

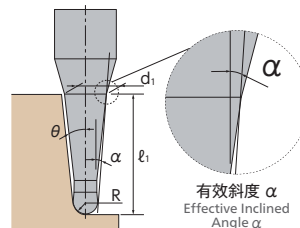

单位 [规格: mm / 价格: 日元]

Unit [Size : mm / Retail Price : JPY]

★ 返修对应 (柄长须在15mm以上。详情请咨询本公司。)

产品代码 Code No.	(R)球头半径 Radius	(θ)颈角 Neck Taper Angle	(ℓ <sub>1</sub> )颈长 Under Neck Length	(d <sub>1</sub> )颈径 Neck Dia.	(ℓ)刃长 Length of Cut	(ℓ <sub>2</sub> )颈长2 Under Neck Length 2	(γ)颈角2 Neck Taper Angle 2	(α)有效斜度 Effective Inclined Angle	(d)柄径 Shank Dia.	(L)全长 Overall Length	定价(日元) Retail Price	
★ 08-00570-06081	R0.6	3°	12	2.21	1.2	2.4	12°	2°32'	4	60	7,600	
★ 08-00570-06082			24	3.46	1.2	2.4	12°	2°46'	6	70	10,700	
★ 08-00570-06091		5°	12	2.88	1.2	2.4	12°	4°13'	4	60	7,600	
★ 08-00570-06092			24	4.98	1.2	2.4	12°	4°37'	6	70	10,700	
★ 08-00570-07520	R0.75	30'	10	1.62	1.5	3	12°	0°23'	4	60	6,900	
★ 08-00570-07521			15	1.71	1.5	3	12°	0°25'	4	60	7,600	
★ 08-00570-07522			30	1.97	1.5	3	12°	0°28'	4	70	10,600	
★ 08-00570-07540		1°	10	1.74	1.5	3	12°	0°45'	4	60	6,900	
★ 08-00570-07541			15	1.92	1.5	3	12°	0°51'	4	60	7,600	
★ 08-00570-07543			20	2.09	1.5	3	12°	0°53'	4	60	8,400	
★ 08-00570-07542			30	2.44	1.5	3	12°	0°55'	4	70	10,600	
★ 08-00570-07550		1°30'	10	1.87	1.5	3	12°	1°08'	4	60	6,900	
★ 08-00570-07551			15	2.13	1.5	3	12°	1°16'	4	60	7,600	
★ 08-00570-07552			30	2.91	1.5	3	12°	1°23'	4	70	10,600	
★ 08-00570-07560			2°	10	1.99	1.5	3	12°	1°31'	4	60	6,900
★ 08-00570-07561		15		2.34	1.5	3	12°	1°41'	4	60	7,600	
★ 08-00570-07563		20		2.69	1.5	3	12°	1°46'	4	60	9,200	
★ 08-00570-07562		3°	30	3.39	1.5	3	12°	1°51'	6	70	12,300	
★ 08-00570-07581			15	2.76	1.5	3	12°	2°32'	4	60	7,600	
★ 08-00570-07583		5°	20	3.28	1.5	3	12°	2°39'	4	60	9,200	
★ 08-00570-07582			30	4.33	1.5	3	12°	2°46'	6	70	12,300	
★ 08-00570-07591		R1	30'	15	3.6	1.5	3	12°	4°13'	6	60	8,800
★ 08-00570-07592				28.7	6	1.5	3	-	4°36'	6	70	12,300
★ 08-00570-10019				12	2.14	2	4	12°	0°21'	4	60	6,100
★ 08-00570-10020	16			2.21	2	4	12°	0°24'	4	60	6,300	
★ 08-00570-10021	20		2.28	2	4	12°	0°25'	4	60	7,600		
★ 08-00570-10022	30		2.45	2	4	12°	0°27'	4	70	9,200		
★ 08-00570-10023	40		2.63	2	4	12°	0°28'	4	80	10,900		
★ 08-00570-10039	1°		12	2.28	2	4	12°	0°43'	4	60	6,100	
★ 08-00570-10040			16	2.42	2	4	12°	0°48'	4	60	6,300	
★ 08-00570-10041			20	2.56	2	4	12°	0°51'	4	60	7,600	
★ 08-00570-10044			25	2.73	2	4	12°	0°53'	4	60	8,400	
★ 08-00570-10042	1°30'		30	2.91	2	4	12°	0°54'	4	70	9,200	
★ 08-00570-10045			35	3.08	2	4	12°	0°55'	4	80	12,000	
★ 08-00570-10043			40	3.26	2	4	12°	0°55'	6	80	13,200	
★ 08-00570-10049			12	2.42	2	4	12°	1°05'	4	60	6,100	
★ 08-00570-10050	1°30'		16	2.63	2	4	12°	1°12'	4	60	6,300	
★ 08-00570-10051		20	2.84	2	4	12°	1°16'	4	60	7,600		
★ 08-00570-10054		25	3.1	2	4	12°	1°19'	4	60	8,400		
★ 08-00570-10052		30	3.36	2	4	12°	1°21'	6	70	11,400		
★ 08-00570-10055		35	3.62	2	4	12°	1°22'	6	80	12,500		
★ 08-00570-10053		40	3.89	2	4	12°	1°23'	6	80	13,200		

锥颈  
Taper Neck

球头  
Ball

涂层  
Coating

P 碳素钢  
Carbon SteelP 合金钢  
Alloy SteelP 调质钢  
Prehardened SteelH ~52高硬度钢  
HRC Hardened SteelM 不锈钢  
Stainless SteelN 铝合金  
Aluminium AlloyN 铜合金  
CopperO 树脂  
Resin

常规系列  
无限涂层  
长颈造型  
Regular Line  
MUGEN COATING  
Long Neck Type

# MRBTN230

## 无限涂层 长颈锥形球头铣刀

MUGEN COATING 2-Flute Long Taper Neck Ball End Mill

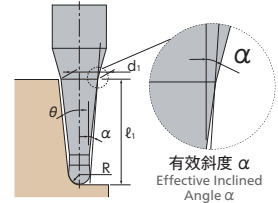

有效斜度  $\alpha$   
Effective Inclined Angle  $\alpha$   
单位 [规格: mm / 价格: 日元]  
Unit [Size: mm / Retail Price: JPY]

★ 返修对应 (柄长须在15mm以上。详情请咨询本公司。)

产品代码 Code No.	(R)球头半径 Radius	( $\theta$ )颈角 Neck Taper Angle	( $\ell_1$ )颈长 Under Neck Length	(d1)颈径 Neck Dia.	( $\ell$ )刃长 Length of Cut	( $\ell_2$ )颈长2 Under Neck Length 2	( $\gamma$ )颈角2 Neck Taper Angle 2	( $\alpha$ )有效斜度 Effective Inclined Angle	(d)柄径 Shank Dia.	(L)全长 Overall Length	定价(日元) Retail Price
★ 08-00570-10059	R1	2°	12	2.56	2	4	12°	1°27′	4	60	6,100
★ 08-00570-10060			16	2.84	2	4	12°	1°36′	4	60	6,300
★ 08-00570-10061			20	3.12	2	4	12°	1°41′	4	60	8,000
★ 08-00570-10062			30	3.82	2	4	12°	1°48′	6	70	11,400
★ 08-00570-10063			40	4.51	2	4	12°	1°51′	6	80	13,200
★ 08-00570-10079		3°	12	2.84	2	4	12°	2°11′	4	60	6,100
★ 08-00570-10080			16	3.26	2	4	12°	2°24′	4	60	6,300
★ 08-00570-10081			20	3.68	2	4	12°	2°31′	6	70	8,800
★ 08-00570-10082			30	4.73	2	4	12°	2°41′	6	70	11,400
★ 08-00570-10083			40	5.77	2	4	12°	2°46′	6	80	13,200
★ 08-00570-10091		5°	20	4.8	2	4	12°	4°13′	6	70	12,100
★ 08-00570-10092			26.8	6	2	4	—	4°25′	6	70	13,000
★ 08-00570-10093			38.2	8	2	4	—	4°36′	8	80	24,200
★ 08-00570-15018		R1.5	30′	15	3.16	3	6	12°	0°20′	6	70
★ 08-00570-15019	20			3.24	3	6	12°	0°22′	6	70	9,400
★ 08-00570-15020	30			3.43	3	6	12°	0°26′	6	70	10,900
★ 08-00570-15022	40			3.6	3	6	12°	0°27′	6	80	12,100
★ 08-00570-15021	50		3.77	3	6	12°	0°27′	6	90	14,100	
★ 08-00570-15038	1°		15	3.31	3	6	12°	0°39′	6	70	8,800
★ 08-00570-15039			20	3.49	3	6	12°	0°45′	6	70	9,400
★ 08-00570-15040			30	3.84	3	6	12°	0°51′	6	70	10,900
★ 08-00570-15042			40	4.19	3	6	12°	0°53′	6	80	12,100
★ 08-00570-15041			50	4.54	3	6	12°	0°54′	6	90	14,100
★ 08-00570-15048		1°30′	15	3.47	3	6	12°	1°00′	6	70	8,800
★ 08-00570-15049	20		3.73	3	6	12°	1°07′	6	70	9,400	
★ 08-00570-15050	30		4.26	3	6	12°	1°16′	6	70	10,900	
★ 08-00570-15052	40		4.78	3	6	12°	1°19′	6	80	12,100	
★ 08-00570-15051	50	5.3	3	6	12°	1°22′	6	90	14,100		
★ 08-00570-15058	2°	15	3.63	3	6	12°	1°20′	6	70	8,800	
★ 08-00570-15059		20	3.98	3	6	12°	1°31′	6	70	9,400	
★ 08-00570-15060		30	4.68	3	6	12°	1°41′	6	70	12,700	
★ 08-00570-15061	48.9	6	3	6	—	1°49′	6	90	14,100		
★ 08-00570-15079	3°	20	4.47	3	6	12°	2°16′	6	70	9,900	
★ 08-00570-15080		30	5.52	3	6	12°	2°32′	6	70	12,700	
★ 08-00570-15081		50	7.61	3	6	12°	2°43′	8	90	25,600	
★ 08-00570-15091	5°	23.1	6	3	6	—	3°58′	6	70	14,100	
★ 08-00570-20019	R2	30′	20	4.21	4	8	12°	0°19′	6	70	11,700
★ 08-00570-20020			40	4.56	4	8	12°	0°25′	6	90	15,400
★ 08-00570-20021			60	4.91	4	8	12°	0°27′	6	110	17,600
★ 08-00570-20039			20	4.42	4	8	12°	0°40′	6	70	11,700
★ 08-00570-20040		1°	40	5.12	4	8	12°	0°50′	6	90	15,400
★ 08-00570-20041			60	5.82	4	8	12°	0°54′	6	110	17,600

订购方法  
How to Order

请指定MRBTN230 球头半径(R)×颈角( $\theta$ )×颈长( $\ell_1$ )。 ※( $\gamma$ )为参考值。  
When you order, indicate MRBTN230 (R)×( $\theta$ )×( $\ell_1$ ). ※( $\gamma$ ) is reference value.