

无限涂层 长颈球头铣刀 (深沟加工用)

共有282种规格

MUGEN COATING 2-Flute Long Neck Ball End Mill

Total 282 sizes

标准长颈球头铣刀 种类丰富, 共有282种规格

Standard type long neck ball end mill. Sufficient variations with 282 sizes

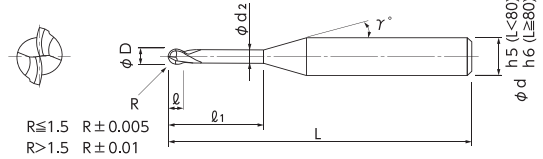
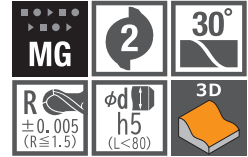

- 适用于深沟加工的长颈避空造型。
- 适用于从低速到高速的深沟精密3D形状加工。
- The Long Neck type is suitable for narrow and deep machining.
- It is possible to have deep and precision three-dimensional cutting in the low to high speed range.

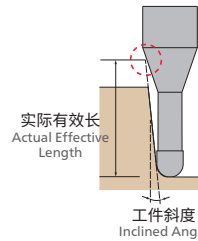

单位 [规格:mm / 价格:日元]
Unit [Size : mm / Retail Price : JPY]

产品代码 Code No.	(R)球头半径 Radius	(l ₁)颈长 Under Neck Length	(l)刃长 Length of Cut	(D)外径 Dia.	(d ₂)颈径 Neck Dia.	(γ)颈角 Neck Taper Angle	(d)柄径 Shank Dia.	(L)全长 Overall Length	定价(日元) Retail Price	相对于工件斜度的有效长 Actual effective length depending on inclined angle of workpiece				
										30°	1°	1°30'	2°	3°
08-00520-20051	R0.05	0.3	0.07	0.1	0.085	12°	4	45	10,700	0.34	0.36	0.37	0.39	0.42
08-00520-20052		0.5	0.07	0.1	0.085	12°	4	45	11,600	0.55	0.57	0.60	0.63	0.69
08-00520-40075	R0.075	0.3	0.1	0.15	0.13	12°	4	45	12,400	0.35	0.37	0.38	0.40	0.43
08-00520-40076		0.5	0.1	0.15	0.13	12°	4	45	13,100	0.56	0.58	0.61	0.64	0.70
08-00520-40077		1	0.1	0.15	0.13	12°	4	45	13,700	1.08	1.13	1.18	1.23	1.36
08-00520-00101	R0.1	0.5	0.15	0.2	0.18	12°	4	45	7,500	0.56	0.58	0.61	0.63	0.69
08-00521-00101		0.5	0.15	0.2	0.18	12°	6	50	10,900	0.56	0.58	0.61	0.63	0.69
08-00520-10101		0.75	0.15	0.2	0.18	12°	4	45	7,500	0.82	0.85	0.89	0.93	1.02
08-00520-00102		1	0.15	0.2	0.18	12°	4	45	7,500	1.08	1.13	1.18	1.23	1.35
08-00521-00102		1	0.15	0.2	0.18	12°	6	50	10,900	1.08	1.13	1.18	1.23	1.35
08-00520-10102		1.25	0.15	0.2	0.18	12°	4	45	8,100	1.34	1.40	1.46	1.53	1.68
08-00520-00103		1.5	0.15	0.2	0.18	12°	4	45	8,100	1.60	1.67	1.75	1.83	2.02
08-00521-00103		1.5	0.15	0.2	0.18	12°	6	50	11,800	1.60	1.67	1.75	1.83	2.02
08-00520-10103		1.75	0.15	0.2	0.18	12°	4	45	8,900	1.86	1.94	2.03	2.13	2.35
08-00520-00104		2	0.15	0.2	0.18	12°	4	45	8,900	2.13	2.22	2.32	2.43	2.68
08-00521-00104	2	0.15	0.2	0.18	12°	6	50	12,800	2.13	2.22	2.32	2.43	2.68	
08-00520-00105	R0.15	2.5	0.15	0.2	0.18	12°	4	45	9,800	2.65	2.76	2.89	3.02	3.34
08-00520-00106		3	0.15	0.2	0.18	12°	4	45	10,500	3.17	3.31	3.46	3.62	4.01
08-00520-40151		0.5	0.2	0.3	0.28	12°	4	45	7,400	0.56	0.58	0.60	0.62	0.67
08-00520-10151		0.6	0.2	0.3	0.28	12°	4	45	7,400	0.66	0.69	0.71	0.74	0.81
08-00520-40152		0.75	0.2	0.3	0.28	12°	4	45	7,400	0.82	0.85	0.88	0.92	1.01
08-00520-00151		1	0.2	0.3	0.28	12°	4	45	7,400	1.08	1.12	1.17	1.22	1.34
08-00521-00151		1	0.2	0.3	0.28	12°	6	50	10,500	1.08	1.12	1.17	1.22	1.34
08-00520-30153		1.25	0.2	0.3	0.28	12°	4	45	7,900	1.34	1.39	1.45	1.52	1.67
08-00520-10152		1.5	0.2	0.3	0.28	12°	4	45	7,900	1.60	1.67	1.74	1.82	2.00
08-00521-00152		1.5	0.2	0.3	0.28	12°	6	50	11,400	1.60	1.67	1.74	1.82	2.00
08-00520-30154	1.75	0.2	0.3	0.28	12°	4	45	7,900	1.86	1.94	2.02	2.12	2.33	
08-00520-00152	2	0.2	0.3	0.28	12°	4	45	7,900	2.12	2.21	2.31	2.42	2.66	
08-00521-00153	2	0.2	0.3	0.28	12°	6	50	11,400	2.12	2.21	2.31	2.42	2.66	
08-00520-30155	2.25	0.2	0.3	0.28	12°	4	45	8,100	2.38	2.48	2.59	2.71	3.00	
08-00520-10153	2.5	0.2	0.3	0.28	12°	4	45	8,100	2.64	2.76	2.88	3.01	3.33	
08-00520-30156	2.75	0.2	0.3	0.28	12°	4	45	8,100	2.91	3.03	3.16	3.31	3.66	

订购方法
How to Order

请指定MRB230 球头半径(R)×颈长(l₁)×柄径(d)。
When you order, indicate MRB230 (R)×(l₁)×(d).

※(γ)为参考值。
※(γ) is reference value.

无限涂层 长颈球头铣刀 (深沟加工用)

MUGEN COATING 2-Flute Long Neck Ball End Mill

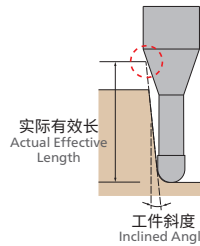

单位 [规格: mm / 价格: 日元]
Unit [Size : mm / Retail Price : JPY]

产品代码 Code No.	(R)球头半径 Radius	(ℓ1)颈长 Under Neck Length	(ℓ)刃长 Length of Cut	(D)外径 Dia.	(d2)颈径 Neck Dia.	(γ)颈角 Neck Taper Angle	(d)柄径 Shank Dia.	(L)全长 Overall Length	定价(日元) Retail Price	相对于工件斜度的有效长 Actual effective length depending on inclined angle of workpiece					
										30°	1°	1°30'	2°	3°	
08-00520-10154	R0.15	3	0.2	0.3	0.28	12°	4	45	8,100	3.17	3.30	3.45	3.61	3.99	
08-00520-30157		3.5	0.2	0.3	0.28	12°	4	45	8,100	3.69	3.85	4.02	4.21	4.65	
08-00520-20151		4	0.2	0.3	0.28	12°	4	45	8,400	4.21	4.39	4.59	4.81	5.32	
08-00520-30158		4.5	0.2	0.3	0.28	12°	4	45	8,400	4.73	4.94	5.16	5.41	5.98	
08-00520-20152		5	0.2	0.3	0.28	12°	4	45	9,500	5.25	5.48	5.73	6.01	6.65	
08-00520-40201	R0.2	0.5	0.3	0.4	0.37	12°	4	45	5,000	0.58	0.60	0.62	0.64	0.69	
08-00520-10201		0.75	0.3	0.4	0.37	12°	4	45	5,000	0.84	0.87	0.90	0.94	1.02	
08-00520-00201		1	0.3	0.4	0.37	12°	4	45	5,000	1.10	1.14	1.19	1.24	1.35	
08-00521-00201		1	0.3	0.4	0.37	12°	6	50	7,700	1.10	1.14	1.19	1.24	1.35	
08-00520-00204		1.5	0.3	0.4	0.37	12°	4	45	5,100	1.62	1.69	1.76	1.84	2.02	
08-00521-00202		1.5	0.3	0.4	0.37	12°	6	50	7,800	1.62	1.69	1.76	1.84	2.02	
08-00520-00202		2	0.3	0.4	0.37	12°	4	45	5,300	2.15	2.23	2.33	2.43	2.68	
08-00521-00203		2	0.3	0.4	0.37	12°	6	50	8,000	2.15	2.23	2.33	2.43	2.68	
08-00520-00205		2.5	0.3	0.4	0.37	12°	4	45	5,500	2.67	2.78	2.90	3.03	3.34	
08-00521-00204		2.5	0.3	0.4	0.37	12°	6	50	8,300	2.67	2.78	2.90	3.03	3.34	
08-00520-00203		3	0.3	0.4	0.37	12°	4	45	5,800	3.19	3.32	3.47	3.63	4.01	
08-00521-00205		3	0.3	0.4	0.37	12°	6	50	8,800	3.19	3.32	3.47	3.63	4.01	
08-00520-10202		3.5	0.3	0.4	0.37	12°	4	45	6,300	3.71	3.87	4.04	4.23	4.67	
08-00520-00206		4	0.3	0.4	0.37	12°	4	45	6,300	4.23	4.41	4.61	4.83	5.33	
08-00520-10203		4.5	0.3	0.4	0.37	12°	4	45	6,600	4.75	4.96	5.18	5.43	6.00	
08-00520-00207		5	0.3	0.4	0.37	12°	4	45	6,600	5.27	5.50	5.75	6.02	6.66	
08-00520-10204		5.5	0.3	0.4	0.37	12°	4	45	7,700	5.80	6.05	6.32	6.62	7.32	
08-00520-10205		6	0.3	0.4	0.37	12°	4	45	7,700	6.32	6.59	6.89	7.22	7.99	
08-00520-30251		R0.25	1	0.35	0.5	0.46	12°	4	45	5,000	1.13	1.16	1.21	1.26	1.37
08-00520-10251			1.5	0.35	0.5	0.46	12°	4	45	5,000	1.65	1.71	1.78	1.85	2.03
08-00521-00251	1.5		0.35	0.5	0.46	12°	6	50	7,700	1.65	1.71	1.78	1.85	2.03	
08-00520-00251	2		0.35	0.5	0.46	12°	4	45	5,000	2.17	2.25	2.35	2.45	2.69	
08-00521-00252	2		0.35	0.5	0.46	12°	6	50	7,700	2.17	2.25	2.35	2.45	2.69	
08-00520-10252	2.5		0.35	0.5	0.46	12°	4	45	5,000	2.69	2.80	2.92	3.05	3.36	
08-00520-10253	3		0.35	0.5	0.46	12°	4	45	5,000	3.21	3.34	3.49	3.65	4.02	
08-00520-10254	3.5		0.35	0.5	0.46	12°	4	45	5,000	3.73	3.89	4.06	4.25	4.69	
08-00520-00252	4		0.35	0.5	0.46	12°	4	45	5,000	4.25	4.43	4.63	4.85	5.35	
08-00521-00253	4		0.35	0.5	0.46	12°	6	50	7,700	4.25	4.43	4.63	4.85	5.35	
08-00520-10255	4.5		0.35	0.5	0.46	12°	4	45	5,100	4.78	4.98	5.20	5.44	6.01	
08-00520-00255	5		0.35	0.5	0.46	12°	4	45	5,100	5.30	5.52	5.77	6.04	6.68	
08-00521-00254	5		0.35	0.5	0.46	12°	6	50	7,800	5.30	5.52	5.77	6.04	6.68	
08-00520-10256	5.5		0.35	0.5	0.46	12°	4	45	5,300	5.82	6.07	6.34	6.64	7.34	
08-00520-00253	6		0.35	0.5	0.46	12°	4	45	5,300	6.34	6.61	6.91	7.24	8.00	
08-00521-00255	6		0.35	0.5	0.46	12°	6	50	8,000	6.34	6.61	6.91	7.24	8.00	
08-00520-10257	7		0.35	0.5	0.46	12°	4	45	6,300	7.38	7.70	8.05	8.44	9.33	
08-00520-00254	8		0.35	0.5	0.46	12°	4	45	6,300	8.42	8.79	9.19	9.63	10.66	
08-00521-00256	8		0.35	0.5	0.46	12°	6	50	9,200	8.42	8.79	9.19	9.63	10.66	
08-00521-30251	9		0.35	0.5	0.46	12°	6	55	7,700	9.47	9.88	10.33	10.83	11.99	
08-00521-30252	10	0.35	0.5	0.46	12°	6	55	8,500	10.51	10.97	11.47	12.03	13.31		

长颈
Long Neck

球头
Ball

涂层
Coating

P 碳素钢
Carbon Steel

P 合金钢
Alloy Steel

P 调质钢
Prehardened Steel

H ~52高硬度钢
HRC Hardened Steel

M 不锈钢
Stainless Steel

N 铝合金
Aluminium Alloy

N 铜合金
Copper

O 树脂
Resin

常规系列
无限涂层
长颈造型
Regular Line
MUGEN COATING
Long Neck Type

MRB230

无限涂层 长颈球头铣刀 (深沟加工用)

MUGEN COATING 2-Flute Long Neck Ball End Mill

球头 Long Neck

涂层 Coating

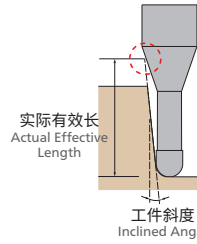

单位 [规格: mm / 价格: 日元]
Unit [Size: mm / Retail Price: JPY]

产品代码 Code No.	(R)球头半径 Radius	(ℓ ₁)颈长 Under Neck Length	(ℓ)刃长 Length of Cut	(D)外径 Dia.	(d ₂)颈径 Neck Dia.	(γ)颈角 Neck Taper Angle	(d)柄径 Shank Dia.	(L)全长 Overall Length	定价(日元) Retail Price	相对于工件斜度的有效长 Actual effective length depending on inclined angle of workpiece				
										30°	1°	1°30'	2°	3°
08-00520-40301	R0.3	1	0.45	0.6	0.56	12°	4	45	4,300	1.12	1.16	1.20	1.25	1.35
08-00520-10301		1.5	0.45	0.6	0.56	12°	4	45	3,900	1.64	1.71	1.77	1.84	2.02
08-00520-00301		2	0.45	0.6	0.56	12°	4	45	3,900	2.17	2.25	2.34	2.44	2.68
08-00521-00301		2	0.45	0.6	0.56	12°	6	50	6,200	2.17	2.25	2.34	2.44	2.68
08-00520-10302		2.5	0.45	0.6	0.56	12°	4	45	4,000	2.69	2.79	2.91	3.04	3.34
08-00520-00305		3	0.45	0.6	0.56	12°	4	45	4,000	3.21	3.34	3.48	3.64	4.01
08-00521-00302		3	0.45	0.6	0.56	12°	6	50	6,300	3.21	3.34	3.48	3.64	4.01
08-00520-10303		3.5	0.45	0.6	0.56	12°	4	45	4,100	3.73	3.88	4.05	4.24	4.67
08-00520-00302		4	0.45	0.6	0.56	12°	4	45	4,100	4.25	4.43	4.62	4.84	5.33
08-00521-00303		4	0.45	0.6	0.56	12°	6	50	6,500	4.25	4.43	4.62	4.84	5.33
08-00520-10304		4.5	0.45	0.6	0.56	12°	4	45	4,100	4.77	4.97	5.19	5.43	6.00
08-00520-00306		5	0.45	0.6	0.56	12°	4	45	4,100	5.29	5.52	5.76	6.03	6.66
08-00520-10305		5.5	0.45	0.6	0.56	12°	4	45	4,100	5.82	6.06	6.33	6.63	7.32
08-00520-00303		6	0.45	0.6	0.56	12°	4	45	4,100	6.34	6.61	6.90	7.23	7.99
08-00521-00304		6	0.45	0.6	0.56	12°	6	50	6,500	6.34	6.61	6.90	7.23	7.99
08-00520-10306		6.5	0.45	0.6	0.56	12°	4	45	4,600	6.86	7.15	7.47	7.83	8.65
08-00520-00307		7	0.45	0.6	0.56	12°	4	45	4,600	7.38	7.70	8.04	8.43	9.31
08-00520-10307		7.5	0.45	0.6	0.56	12°	4	45	5,500	7.90	8.24	8.61	9.02	9.98
08-00520-00304		8	0.45	0.6	0.56	12°	4	45	5,500	8.42	8.79	9.18	9.62	10.64
08-00521-00305		8	0.45	0.6	0.56	12°	6	50	8,300	8.42	8.79	9.18	9.62	10.64
08-00520-10308	8.5	0.45	0.6	0.56	12°	4	45	5,800	8.94	9.33	9.76	10.22	11.31	
08-00520-10309	9	0.45	0.6	0.56	12°	4	45	5,800	9.47	9.88	10.33	10.82	11.97	
08-00520-10310	9.5	0.45	0.6	0.56	12°	4	45	5,800	9.99	10.42	10.90	11.42	12.63	
08-00520-10311	10	0.45	0.6	0.56	12°	4	45	5,600	10.51	10.97	11.47	12.02	13.30	
08-00521-00306	10	0.45	0.6	0.56	12°	6	50	8,800	10.51	10.97	11.47	12.02	13.30	
08-00520-10312	11	0.45	0.6	0.56	12°	4	45	6,300	11.55	12.06	12.61	13.21	14.62	
08-00520-10313	12	0.45	0.6	0.56	12°	4	45	6,300	12.59	13.14	13.75	14.41	15.95	
08-00520-40351	R0.35	2	0.5	0.7	0.66	12°	4	45	3,900	2.16	2.25	2.33	2.43	2.66
08-00520-40352		4	0.5	0.7	0.66	12°	4	45	4,100	4.25	4.42	4.62	4.83	5.32
08-00520-40353		6	0.5	0.7	0.66	12°	4	45	4,100	6.34	6.60	6.90	7.22	7.97
08-00520-40354		8	0.5	0.7	0.66	12°	4	45	4,100	8.42	8.78	9.18	9.61	10.63
08-00520-00400	2	0.6	0.8	0.76	12°	4	45	3,900	2.16	2.24	2.33	2.42	2.65	
08-00521-00401	2	0.6	0.8	0.76	12°	6	50	6,200	2.16	2.24	2.33	2.42	2.65	
08-00520-10401	3	0.6	0.8	0.76	12°	4	45	4,100	3.20	3.33	3.47	3.62	3.97	
08-00521-00402	3	0.6	0.8	0.76	12°	6	50	6,500	3.20	3.33	3.47	3.62	3.97	
08-00520-00401	4	0.6	0.8	0.76	12°	4	45	4,100	4.25	4.42	4.61	4.82	5.30	
08-00521-00403	4	0.6	0.8	0.76	12°	6	50	6,500	4.25	4.42	4.61	4.82	5.30	
08-00520-00405	R0.4	5	0.6	0.8	0.76	12°	4	45	4,100	5.29	5.51	5.75	6.01	6.63
08-00520-00402		6	0.6	0.8	0.76	12°	4	45	4,100	6.33	6.60	6.89	7.21	7.96
08-00521-00404		6	0.6	0.8	0.76	12°	6	50	6,500	6.33	6.60	6.89	7.21	7.96
08-00520-00406		7	0.6	0.8	0.76	12°	4	45	4,100	7.38	7.69	8.03	8.41	9.28
08-00520-00403		8	0.6	0.8	0.76	12°	4	45	4,100	8.42	8.78	9.17	9.60	10.61
08-00521-00405		8	0.6	0.8	0.76	12°	6	50	6,500	8.42	8.78	9.17	9.60	10.61
08-00520-30401		9	0.6	0.8	0.76	12°	4	45	5,500	9.46	9.87	10.31	10.80	11.94

订购方法
How to Order

请指定MRB230 球头半径(R)×颈长(ℓ₁)×柄径(d)。
When you order, indicate MRB230 (R)×(ℓ₁)×(d).

※(γ)为参考值。
※(γ) is reference value.

- 碳素钢 Carbon Steel P
- 合金钢 Alloy Steel P
- 调质钢 Prehardened Steel P
- 高硬度钢~S2 Hardened Steel HRC H

不锈钢 Stainless Steel M

铝合金 Aluminium Alloy N

铜合金 Copper N

树脂 Resin O

无限涂层 长颈球头铣刀 (深沟加工用)

MUGEN COATING 2-Flute Long Neck Ball End Mill

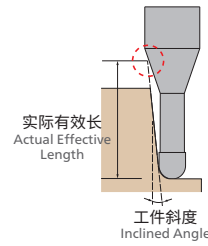

单位 [规格: mm / 价格: 日元]
Unit [Size : mm / Retail Price : JPY]

产品代码 Code No.	(R)球头半径 Radius	(ℓ1)颈长 Under Neck Length	(ℓ)刃长 Length of Cut	(D)外径 Dia.	(d2)颈径 Neck Dia.	(γ)颈角 Neck Taper Angle	(d)柄径 Shank Dia.	(L)全长 Overall Length	定价(日元) Retail Price	相对于工件斜度的有效长 Actual effective length depending on inclined angle of workpiece				
										30°	1°	1°30'	2°	3°
08-00520-00404	R0.4	10	0.6	0.8	0.76	12°	4	45	5,500	10.50	10.96	11.45	12.00	13.26
08-00521-00406		10	0.6	0.8	0.76	12°	6	50	8,300	10.50	10.96	11.45	12.00	13.26
08-00520-20401		12	0.6	0.8	0.76	12°	4	45	6,700	12.59	13.14	13.73	14.39	15.92
08-00520-40451	R0.45	2	0.65	0.9	0.86	12°	4	45	3,900	2.16	2.24	2.32	2.41	2.63
08-00520-40452		4	0.65	0.9	0.86	12°	4	45	4,100	4.25	4.42	4.60	4.81	5.29
08-00520-40453		6	0.65	0.9	0.86	12°	4	45	4,100	6.33	6.59	6.88	7.20	7.94
08-00520-40454	R0.5	8	0.65	0.9	0.86	12°	4	45	4,100	8.42	8.77	9.16	9.59	10.59
08-00520-40501		2	0.75	1	0.95	12°	4	45	3,300	2.18	2.26	2.34	2.43	2.65
08-00520-40502		2.5	0.75	1	0.95	12°	4	45	3,300	2.70	2.80	2.91	3.03	3.31
08-00520-00505	R0.5	3	0.75	1	0.95	12°	4	45	3,300	3.22	3.35	3.48	3.63	3.97
08-00521-00501		3	0.75	1	0.95	12°	6	50	5,400	3.22	3.35	3.48	3.63	3.97
08-00520-00506		4	0.75	1	0.95	12°	4	45	3,700	4.27	4.44	4.62	4.83	5.30
08-00521-00502		4	0.75	1	0.95	12°	6	50	5,900	4.27	4.44	4.62	4.83	5.30
08-00520-00510		5	0.75	1	0.95	12°	4	45	3,700	5.31	5.53	5.76	6.02	6.63
08-00521-00503		5	0.75	1	0.95	12°	6	50	5,900	5.31	5.53	5.76	6.02	6.63
08-00520-00501		6	0.75	1	0.95	12°	4	45	4,000	6.35	6.62	6.90	7.22	7.96
08-00521-00504		6	0.75	1	0.95	12°	6	50	6,300	6.35	6.62	6.90	7.22	7.96
08-00520-00511		7	0.75	1	0.95	12°	4	45	4,000	7.40	7.71	8.04	8.42	9.28
08-00520-00502		8	0.75	1	0.95	12°	4	45	4,000	8.44	8.79	9.18	9.61	10.61
08-00521-00505		8	0.75	1	0.95	12°	6	50	6,300	8.44	8.79	9.18	9.61	10.61
08-00520-00512		9	0.75	1	0.95	12°	4	45	4,000	9.48	9.88	10.32	10.81	11.94
08-00521-00507	10	0.75	1	0.95	12°	4	45	4,000	10.52	10.97	11.46	12.01	13.26	
08-00520-00506	10	0.75	1	0.95	12°	6	50	6,300	10.52	10.97	11.46	12.01	13.26	
08-00520-00504	12	0.75	1	0.95	12°	4	45	4,000	12.61	13.15	13.75	14.40	15.92	
08-00521-00507	12	0.75	1	0.95	12°	6	50	6,300	12.61	13.15	13.75	14.40	15.92	
08-00520-40503	13	0.75	1	0.95	12°	4	45	4,600	13.65	14.24	14.89	15.59	17.25	
08-00520-00513	14	0.75	1	0.95	12°	4	50	4,600	14.70	15.33	16.03	16.79	18.57	
08-00520-00508	16	0.75	1	0.95	12°	4	50	5,500	16.78	17.51	18.31	19.18	21.23	
08-00521-00508	16	0.75	1	0.95	12°	6	60	8,300	16.78	17.51	18.31	19.18	21.23	
08-00520-00514	18	0.75	1	0.95	12°	4	55	5,500	18.87	19.69	20.59	21.58	23.88	
08-00520-00509	20	0.75	1	0.95	12°	4	55	6,600	20.95	21.87	22.87	23.97	26.54	
08-00521-00509	20	0.75	1	0.95	12°	6	60	9,800	20.95	21.87	22.87	23.97	26.54	
08-00521-00510	22	0.75	1	0.95	12°	6	60	10,200	23.04	24.05	25.15	26.36	29.19	
08-00520-40601	R0.6	2.4	0.9	1.2	1.15	12°	4	45	4,900	2.59	2.68	2.78	2.89	3.15
08-00520-20601		4	0.9	1.2	1.15	12°	4	45	4,900	4.26	4.43	4.61	4.81	5.27
08-00520-00600		6	0.9	1.2	1.15	12°	4	45	5,400	6.35	6.61	6.89	7.20	7.92
08-00521-00601		6	0.9	1.2	1.15	12°	6	50	8,000	6.35	6.61	6.89	7.20	7.92
08-00520-00601		8	0.9	1.2	1.15	12°	4	45	5,400	8.43	8.79	9.17	9.59	10.58
08-00521-00602		8	0.9	1.2	1.15	12°	6	50	8,000	8.43	8.79	9.17	9.59	10.58
08-00520-00602		10	0.9	1.2	1.15	12°	4	45	5,400	10.52	10.96	11.45	11.99	13.23
08-00521-00603		10	0.9	1.2	1.15	12°	6	50	8,000	10.52	10.96	11.45	11.99	13.23
08-00520-00603		12	0.9	1.2	1.15	12°	4	45	5,400	12.61	13.14	13.73	14.38	15.89
08-00521-00604		12	0.9	1.2	1.15	12°	6	50	8,000	12.61	13.14	13.73	14.38	15.89
08-00520-10601		14	0.9	1.2	1.15	12°	4	50	5,800	14.69	15.32	16.01	16.77	18.54

长颈
Long Neck

球头
Ball

涂层
Coating

P 碳素钢
Carbon Steel

P 合金钢
Alloy Steel

P 调质钢
Prehardened Steel

H ~52高硬度钢
HRC Hardened Steel

M 不锈钢
Stainless Steel

N 铝合金
Aluminium Alloy

N 铜合金
Copper

O 树脂
Resin

常规系列
无限涂层
长颈造型
Regular Line
MUGEN COATING
Long Neck Type

MRB230

无限涂层 长颈球头铣刀 (深沟加工用)

MUGEN COATING 2-Flute Long Neck Ball End Mill

球头 Long Neck

涂层 Coating

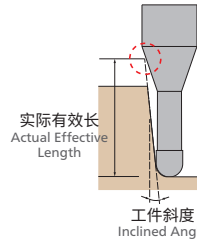

单位 [规格: mm / 价格: 日元]
Unit [Size : mm / Retail Price : JPY]

产品代码 Code No.	(R)球头半径 Radius	(ℓ ₁)颈长 Under Neck Length	(ℓ)刃长 Length of Cut	(D)外径 Dia.	(d ₂)颈径 Neck Dia.	(γ)颈角 Neck Taper Angle	(d)柄径 Shank Dia.	(L)全长 Overall Length	定价(日元) Retail Price	相对于工件斜度的有效长 Actual effective length depending on inclined angle of workpiece				
										30°	1°	1°30'	2°	3°
08-00520-10602	R0.6	16	0.9	1.2	1.15	12°	4	50	6,300	16.78	17.50	18.29	19.17	21.20
08-00521-00605		16	0.9	1.2	1.15	12°	6	60	9,100	16.78	17.50	18.29	19.17	21.20
08-00520-20602		18	0.9	1.2	1.15	12°	4	55	6,800	18.86	19.68	20.58	21.56	23.85
08-00520-30601		20	0.9	1.2	1.15	12°	4	55	6,800	20.95	21.86	22.86	23.95	26.50
08-00520-20603		24	0.9	1.2	1.15	12°	4	60	8,900	25.12	26.22	27.42	28.74	Free
08-00520-30701	R0.7	8	1	1.4	1.35	12°	4	45	4,600	8.43	8.78	9.16	9.57	10.55
08-00520-30702		12	1	1.4	1.35	12°	4	50	4,600	12.60	13.13	13.72	14.36	15.85
08-00520-30703		16	1	1.4	1.35	12°	4	50	4,600	16.77	17.49	18.28	19.15	21.16
08-00520-30751	R0.75	3	1.1	1.5	1.45	12°	4	45	3,800	3.21	3.33	3.45	3.58	3.89
08-00520-20751		4	1.1	1.5	1.45	12°	4	45	3,800	4.26	4.41	4.59	4.78	5.22
08-00520-20752		6	1.1	1.5	1.45	12°	4	45	3,800	6.34	6.59	6.87	7.17	7.88
08-00520-00751		8	1.1	1.5	1.45	12°	4	45	4,000	8.43	8.77	9.15	9.56	10.53
08-00521-00751		8	1.1	1.5	1.45	12°	6	50	6,400	8.43	8.77	9.15	9.56	10.53
08-00520-00752		10	1.1	1.5	1.45	12°	4	45	4,300	10.51	10.95	11.43	11.96	13.18
08-00520-00753		12	1.1	1.5	1.45	12°	4	45	4,600	12.60	13.13	13.71	14.35	15.84
08-00521-00752		12	1.1	1.5	1.45	12°	6	50	7,300	12.60	13.13	13.71	14.35	15.84
08-00520-00754		14	1.1	1.5	1.45	12°	4	50	4,600	14.69	15.31	15.99	16.74	18.49
08-00520-00755		16	1.1	1.5	1.45	12°	4	50	4,600	16.77	17.49	18.27	19.14	21.15
08-00521-00755		16	1.1	1.5	1.45	12°	6	60	7,300	16.77	17.49	18.27	19.14	21.15
08-00520-00756		18	1.1	1.5	1.45	12°	4	55	4,600	18.86	19.67	20.55	21.53	23.80
08-00520-00757		20	1.1	1.5	1.45	12°	4	55	4,600	20.94	21.85	22.84	23.92	Free
08-00521-00757		20	1.1	1.5	1.45	12°	6	60	7,300	20.94	21.85	22.84	23.92	26.46
08-00520-10751		22	1.1	1.5	1.45	12°	4	55	4,600	23.03	24.02	25.12	26.32	Free
08-00520-20753	30	1.1	1.5	1.45	12°	4	70	7,600	31.37	32.74	34.24	35.89	Free	
08-00520-20801	R0.8	4	1.2	1.6	1.55	12°	4	45	5,300	4.25	4.41	4.58	4.77	5.21
08-00520-00801		8	1.2	1.6	1.55	12°	4	45	5,400	8.43	8.77	9.14	9.55	10.51
08-00520-00803		12	1.2	1.6	1.55	12°	4	45	5,400	12.60	13.13	13.70	14.34	15.82
08-00520-00805		16	1.2	1.6	1.55	12°	4	50	5,400	16.77	17.48	18.27	19.13	21.13
08-00520-00807		20	1.2	1.6	1.55	12°	4	55	5,400	20.94	21.84	22.83	23.91	Free
08-00520-30901	R0.9	8	1.3	1.8	1.75	12°	4	45	4,600	8.42	8.76	9.13	9.53	10.48
08-00520-30902		12	1.3	1.8	1.75	12°	4	45	4,600	12.59	13.12	13.69	14.32	15.79
08-00520-30903		16	1.3	1.8	1.75	12°	4	50	4,600	16.76	17.47	18.25	19.11	21.10
08-00520-30904	20	1.3	1.8	1.75	12°	4	55	4,600	20.94	21.83	22.81	23.89	Free	
08-00520-31001	R1	3	1.5	2	1.94	12°	4	45	3,300	3.23	3.33	3.44	3.56	3.85
08-00520-01000		4	1.5	2	1.94	12°	4	45	3,300	4.27	4.42	4.58	4.76	5.17
08-00521-01000		4	1.5	2	1.94	12°	6	50	5,400	4.27	4.42	4.58	4.76	5.17
08-00520-01001		6	1.5	2	1.94	12°	4	45	3,700	6.36	6.60	6.86	7.15	7.83
08-00521-01001		6	1.5	2	1.94	12°	6	50	5,800	6.36	6.60	6.86	7.15	7.83
08-00520-01002		8	1.5	2	1.94	12°	4	45	4,000	8.44	8.78	9.14	9.54	10.48
08-00521-01002		8	1.5	2	1.94	12°	6	50	6,300	8.44	8.78	9.14	9.54	10.48
08-00520-01003		10	1.5	2	1.94	12°	4	45	4,000	10.53	10.95	11.42	11.94	13.14
08-00521-01003		10	1.5	2	1.94	12°	6	50	6,300	10.53	10.95	11.42	11.94	13.14
08-00520-01004		12	1.5	2	1.94	12°	4	45	4,000	12.61	13.13	13.70	14.33	15.79
08-00521-01004		12	1.5	2	1.94	12°	6	50	6,300	12.61	13.13	13.70	14.33	15.79

订购方法
How to Order

请指定MRB230 球头半径(R)×颈长(ℓ₁)×柄径(d)。
When you order, indicate MRB230 (R)×(ℓ₁)×(d).

※(γ)为参考值。
※(γ) is reference value.

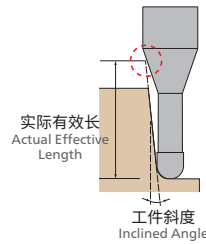

单位 [规格: mm / 价格: 日元]
Unit [Size : mm / Retail Price : JPY]

产品代码 Code No.	(R)球头半径 Radius	(ℓ ₁)颈长 Under Neck Length	(ℓ)刃长 Length of Cut	(D)外径 Dia.	(d ₂)颈径 Neck Dia.	(γ)颈角 Neck Taper Angle	(d)柄径 Shank Dia.	(L)全长 Overall Length	定价(日元) Retail Price	相对于工件斜度的有效长 Actual effective length depending on inclined angle of workpiece				
										30°	1°	1°30′	2°	3°
08-00520-41001	R1	13	1.5	2	1.94	12°	4	45	4,000	13.66	14.22	14.84	15.53	17.12
08-00520-01005		14	1.5	2	1.94	12°	4	50	4,000	14.70	15.31	15.98	16.72	18.45
08-00520-01006		16	1.5	2	1.94	12°	4	50	4,000	16.78	17.49	18.27	19.12	Free
08-00521-01005		16	1.5	2	1.94	12°	6	60	6,300	16.78	17.49	18.27	19.12	21.10
08-00520-01007		18	1.5	2	1.94	12°	4	55	4,000	18.87	19.67	20.55	21.51	Free
08-00520-01008		20	1.5	2	1.94	12°	4	55	4,000	20.96	21.85	22.83	23.90	Free
08-00521-01008		20	1.5	2	1.94	12°	6	60	6,300	20.96	21.85	22.83	23.90	26.41
08-00520-01009		22	1.5	2	1.94	12°	4	60	5,500	23.04	24.03	25.11	26.30	Free
08-00520-01010		25	1.5	2	1.94	12°	4	65	5,600	26.17	27.30	28.53	Free	Free
08-00521-01010		25	1.5	2	1.94	12°	6	80	8,300	26.17	27.30	28.53	29.89	33.04
08-00520-01011		30	1.5	2	1.94	12°	4	70	6,300	31.38	32.74	34.23	Free	Free
08-00521-01012		30	1.5	2	1.94	12°	6	80	9,400	31.38	32.74	34.23	35.87	Free
08-00520-11001		35	1.5	2	1.94	12°	4	70	8,600	36.60	38.19	Free	Free	Free
08-00521-01014		35	1.5	2	1.94	12°	6	80	12,200	36.60	38.19	39.93	41.85	Free
08-00520-31002		40	1.5	2	1.94	12°	4	90	8,600	41.81	43.64	Free	Free	Free
08-00521-01015		40	1.5	2	1.94	12°	6	90	12,200	41.81	43.64	45.64	47.83	Free
08-00520-21251	R1.25	6	2.3	2.5	2.4	12°	4	45	4,300	6.44	6.68	6.93	7.21	7.87
08-00520-11251		10	2.3	2.5	2.4	12°	4	45	4,500	10.62	11.04	11.49	12.00	13.18
08-00520-11252		15	2.3	2.5	2.4	12°	4	50	5,400	15.83	16.48	17.20	17.98	Free
08-00520-11253		20	2.3	2.5	2.4	12°	4	55	6,300	21.04	21.93	22.90	Free	Free
08-00520-11254		25	2.3	2.5	2.4	12°	4	65	6,700	26.26	27.38	28.60	Free	Free
08-00520-11255		30	2.3	2.5	2.4	12°	4	70	6,700	31.47	32.82	Free	Free	Free
08-00520-21252		35	2.3	2.5	2.4	12°	4	70	7,800	36.69	38.27	Free	Free	Free
08-00520-31502	R1.5	6	2.5	3	2.85	12°	4	60	3,700	6.56	6.78	7.03	7.31	7.95
08-00520-31503		6	2.5	3	2.85	12°	6	60	4,200	6.56	6.78	7.03	7.31	7.95
08-00520-01500		8	2.5	3	2.85	12°	6	60	4,200	8.64	8.96	9.31	9.70	10.60
08-00520-01501		10	2.5	3	2.85	12°	6	60	4,800	10.73	11.14	11.59	12.09	13.26
08-00520-31504		12	2.5	3	2.85	12°	6	60	5,100	12.81	13.32	13.88	14.49	15.91
08-00520-31505		14	2.5	3	2.85	12°	6	60	5,600	14.90	15.50	16.16	16.88	18.57
08-00520-01503		15	2.5	3	2.85	12°	6	60	5,500	15.94	16.59	17.30	18.08	19.89
08-00520-31506		16	2.5	3	2.85	12°	6	60	5,600	16.98	17.68	18.44	19.27	21.22
08-00520-01505		20	2.5	3	2.85	12°	6	65	5,400	21.16	22.04	23.00	24.06	26.53
08-00520-01506		25	2.5	3	2.85	12°	6	65	5,400	26.37	27.48	28.70	30.04	Free
08-00520-01507		30	2.5	3	2.85	12°	6	70	6,200	31.58	32.93	34.40	36.03	Free
08-00520-01508		35	2.5	3	2.85	12°	6	80	7,800	36.80	38.38	40.11	42.01	Free
08-00520-11501		40	2.5	3	2.85	12°	6	90	9,700	42.01	43.83	45.81	Free	Free
08-00520-11751		R1.75	10	2.8	3.5	3.35	12°	6	60	6,200	10.72	11.12	11.56	12.05
08-00520-11752	15		2.8	3.5	3.35	12°	6	60	6,200	15.93	16.57	17.26	18.03	19.81
08-00520-11753	20		2.8	3.5	3.35	12°	6	65	6,600	21.14	22.01	22.96	24.01	Free
08-00520-11754	25		2.8	3.5	3.35	12°	6	65	6,600	26.36	27.46	28.67	29.99	Free
08-00520-11755	30		2.8	3.5	3.35	12°	6	70	7,000	31.57	32.91	34.37	35.98	Free
08-00520-11756	35		2.8	3.5	3.35	12°	6	80	8,500	36.79	38.36	40.07	Free	Free
08-00520-11757	40		2.8	3.5	3.35	12°	6	90	9,400	42.00	43.80	45.77	Free	Free
08-00520-11758	45		2.8	3.5	3.35	12°	6	90	10,200	47.22	49.25	Free	Free	Free

长颈
Long Neck球头
Ball涂层
CoatingP 碳素钢
Carbon SteelP 合金钢
Alloy SteelP 调质钢
Prehardened SteelH ~52高硬度钢
HRC Hardened SteelM 不锈钢
Stainless SteelN 铝合金
Aluminium AlloyN 铜合金
CopperO 树脂
Resin

常规系列
无限涂层
长颈造型
Regular Line
MUGEN COATING
Long Neck Type

MRB230

无限涂层 长颈球头铣刀 (深沟加工用)

MUGEN COATING 2-Flute Long Neck Ball End Mill

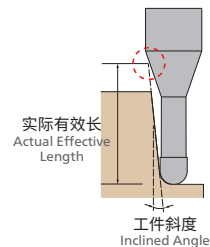

单位 [规格:mm / 价格:日元]
Unit [Size : mm / Retail Price : JPY]

产品代码 Code No.	(R)球头半径 Radius	(ℓ1)颈长 Under Neck Length	(ℓ)刃长 Length of Cut	(D)外径 Dia.	(d2)颈径 Neck Dia.	(γ)颈角 Neck Taper Angle	(d)柄径 Shank Dia.	(L)全长 Overall Length	定价(日元) Retail Price	相对于工件斜度的有效长 Actual effective length depending on inclined angle of workpiece				
										30°	1°	1°30'	2°	3°
08-00520-02000	R2	10	3	4	3.8	12°	6	65	4,300	10.83	11.22	11.66	12.14	13.25
08-00520-32001		12	3	4	3.8	12°	6	65	5,600	12.91	13.40	13.94	14.53	15.91
08-00520-32002		14	3	4	3.8	12°	6	65	5,600	15.00	15.58	16.22	16.92	18.56
08-00520-02001		15	3	4	3.8	12°	6	65	5,600	16.04	16.67	17.36	18.12	19.89
08-00520-32003		16	3	4	3.8	12°	6	65	5,600	17.09	17.76	18.50	19.32	Free
08-00520-02003		20	3	4	3.8	12°	6	65	5,600	21.26	22.12	23.06	24.10	Free
08-00520-02004		25	3	4	3.8	12°	6	70	5,600	26.47	27.57	28.77	30.09	Free
08-00520-02005		30	3	4	3.8	12°	6	70	5,600	31.68	33.01	34.47	Free	Free
08-00520-02006		35	3	4	3.8	12°	6	80	6,500	36.90	38.46	Free	Free	Free
08-00520-02007		40	3	4	3.8	12°	6	85	7,300	42.11	43.91	Free	Free	Free
08-00520-02008	45	3	4	3.8	12°	6	90	9,400	47.33	49.36	Free	Free	Free	
08-00520-02009	50	3	4	3.8	12°	6	100	10,000	52.54	54.80	Free	Free	Free	
08-00520-32501	R2.5	10	3.5	5	4.8	12°	6	70	6,600	10.81	11.18	11.59	12.04	Free
08-00520-12501		15	3.5	5	4.8	12°	6	70	9,400	16.02	16.63	17.29	Free	Free
08-00520-02501		20	3.5	5	4.8	12°	6	70	9,400	21.24	22.08	Free	Free	Free
08-00520-02502		25	3.5	5	4.8	12°	6	70	9,400	26.45	27.52	Free	Free	Free
08-00520-02503		30	3.5	5	4.8	12°	6	80	10,000	31.66	Free	Free	Free	Free
08-00520-02504		35	3.5	5	4.8	12°	6	80	10,000	36.88	Free	Free	Free	Free
08-00520-12502		40	3.5	5	4.8	12°	6	90	12,700	42.09	Free	Free	Free	Free
08-00520-12503		45	3.5	5	4.8	12°	6	100	13,200	47.31	Free	Free	Free	Free
08-00520-12504		50	3.5	5	4.8	12°	6	100	14,300	52.52	Free	Free	Free	Free
08-00520-33001		R3	10	6	6	5.8	-	6	70	7,000	Free	Free	Free	Free
08-00520-43001	15		6	6	5.8	-	6	70	7,000	Free	Free	Free	Free	Free
08-00520-13001	20		6	6	5.8	-	6	70	7,000	Free	Free	Free	Free	Free
08-00520-13002	25		6	6	5.8	-	6	70	7,000	Free	Free	Free	Free	Free
08-00520-03001	30		6	6	5.8	-	6	80	7,300	Free	Free	Free	Free	Free
08-00520-13003	35		6	6	5.8	-	6	80	7,500	Free	Free	Free	Free	Free
08-00520-13004	40		6	6	5.8	-	6	90	7,900	Free	Free	Free	Free	Free
08-00520-13005	45		6	6	5.8	-	6	100	8,500	Free	Free	Free	Free	Free
08-00520-03003	50		6	6	5.8	-	6	120	8,600	Free	Free	Free	Free	Free

订购方法 How to Order

请指定MRB230 球头半径(R)×颈长(ℓ1)×柄径(d)。 ※(γ)为参考值。
When you order, indicate MRB230 (R)×(ℓ1)×(d). ※(γ) is reference value.

- 碳素钢 P
Carbon Steel
- 合金钢 P
Alloy Steel
- 调质钢 P
Prehardened Steel
- 高硬度钢~52 HRC H
Hardened Steel
- 不锈钢 M
Stainless Steel
- 铝合金 N
Aluminium Alloy
- 铜合金 N
Copper
- 树脂 O
Resin

常规系列
无限涂层
长颈造型
Regular Line
MUGEN COATING
Long Neck Type