

MHDH445R

规格

Size $\phi 3 \times R0.2 \sim \phi 4 \times R0.5$

∞ Premium

≤65 HRC

无限白金涂层 高硬度钢材用4刃圆鼻铣刀

MUGEN COATING PREMIUM 4-Flute Corner Radius End Mill for Hardened Steel

共有6种规格

Total 6 sizes

4刃强螺旋角，可对应高硬度钢(~65HRC)的圆鼻铣刀

4-flute high helix angle corner radius end mill for hardened steels up to 65HRC

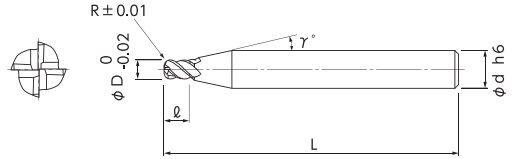
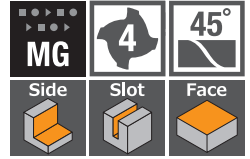

- 在高硬度领域 (48~65HRC) 的长时间加工中也可实现稳定的延长刀具寿命。
- 强螺旋角，锋利度更高，圆鼻形状可抑制崩刀。
- Realized stably long tool life against high hardened steels (48~65HRC).
- Corner radius to prevent flute chipping, and high helix angle for cutting sharpness.

★ 返修对应 (柄长须在15mm以上。详情请咨询本公司。)

单位 [规格: mm / 价格: 日元]
Unit [Size: mm / Retail Price: JPY]

产品代码 Code No.	(D)外径 Dia.	(R)角半径 Corner Radius	(ℓ)刃长 Length of Cut	(γ)颈角 Neck Taper Angle	(d)柄径 Shank Dia.	(L)全长 Overall Length	定价(日元) Retail Price
★ 08-00437-03002	3	R0.2	6	12°	6	60	13,800
★ 08-00437-03003		R0.3	6	12°	6	60	13,800
★ 08-00437-03005		R0.5	6	12°	6	60	13,800
★ 08-00437-04002	4	R0.2	8	12°	6	60	14,900
★ 08-00437-04003		R0.3	8	12°	6	60	14,900
★ 08-00437-04005		R0.5	8	12°	6	60	14,900

订购方法
How to Order

请指定MHDH445R 外径(D)×角半径(R)。 ※(γ)为参考值。
When you order, indicate MHDH445R (D)×(R). ※(γ) is reference value.

调质钢 P
Prehardened Steel

高硬度钢~52 H
Hardened Steel HRC

高硬度钢~60 H
Hardened Steel HRC

高硬度钢~65 H
Hardened Steel HRC

常规系列
无限白金涂层
全刃长造型
Regular Line
MUGEN PREMIUM
Full Cutting Length Type