

# SSPBTN220

规格 R0.1 × 颈角30' ~ R1 × 颈角2°  
Size R0.1 × neck taper angle30' ~ R1 × neck taper angle2°



CBN超精加工用长颈锥形螺旋球头铣刀

共有64种规格

CBN Super Spiral Long Taper Neck Ball End Mill

Total 64 sizes

采用锥颈造型，具有高刚性  
适用于高精度深沟加工

Taper neck design for high rigidity.  
Suitable for deep and high accurate finishing

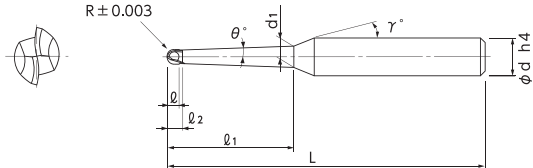

- CBN长颈球头铣刀采用锥颈形状，可实现高刚性。
- 搭配螺旋球头形状，提高了锋利度，提升了深沟精加工的精度与效率。
- To realize more rigid, CBN long neck ball end mill with taper neck are adopted.
- Both efficiency and accuracy are increasing by taper neck design and spiral ball shape with improved sharpness in finish machining on deep milling.



刃刃形状  
Cutting edge shape

★返修对应（柄长须在15mm以上。详情请咨询本公司。）

单位 [规格: mm / 价格: 日元]  
Unit [Size: mm / Retail Price: JPY]

| 产品代码<br>Code No. | (R)球头半径<br>Radius | (θ)颈角<br>Neck Taper Angle | (ℓ <sub>1</sub> )颈长<br>Under Neck Length | (α)有效斜度<br>Effective Inclined Angle | (d <sub>1</sub> )颈径<br>Neck Dia. | (ℓ)刃长<br>Length of Cut | (ℓ <sub>2</sub> )颈长<br>Under Neck Length2 | (γ)颈角<br>Neck Taper Angle | (d)柄径<br>Shank Dia. | (L)全长<br>Overall Length | 定价(日元)<br>Retail Price |        |
|------------------|-------------------|---------------------------|--|-------------------------------------|----------------------------------|------------------------|---|---------------------------|---------------------|-------------------------|------------------------|--------|
| 01-00507-01020   | R0.1              | 30'                       | 1.5                                      | 0°15'                               | 0.22                             | 0.15                   | 0.25                                      | 15°                       | 4                   | 50                      | 38,000                 |        |
| 01-00507-01021   |                   |                           | 2  | 0°15'                               | 0.22                             | 0.15                   | 0.25                                      | 15°                       | 4                   | 50                      | 38,500                 |        |
| 01-00507-01030   |                   | 1°                        | 1.5                                      | 0°45'                               | 0.24                             | 0.15                   | 0.25                                      | 15°                       | 4                   | 50                      | 38,000                 |        |
| 01-00507-01031   |                   |                           | 2  | 0°45'                               | 0.25                             | 0.15                   | 0.25                                      | 15°                       | 4                   | 50                      | 38,500                 |        |
| 01-00507-01040   |                   | 1°30'                     | 1.5                                      | 1°15'                               | 0.27                             | 0.15                   | 0.25                                      | 15°                       | 4                   | 50                      | 38,000                 |        |
| 01-00507-01041   |                   |                           | 2  | 1°15'                               | 0.29                             | 0.15                   | 0.25                                      | 15°                       | 4                   | 50                      | 38,500                 |        |
| 01-00507-01050   |                   | 2°                        | 1.5                                      | 1°45'                               | 0.29                             | 0.15                   | 0.25                                      | 15°                       | 4                   | 50                      | 38,000                 |        |
| 01-00507-01051   |                   |                           | 2  | 1°45'                               | 0.32                             | 0.15                   | 0.25                                      | 15°                       | 4                   | 50                      | 38,500                 |        |
| 01-00507-01520   |                   | R0.15                     | 30'                                      | 2                                   | 0°16'                            | 0.32                   | 0.23                                      | 0.38                      | 15°                 | 4                       | 50                     | 36,000 |
| 01-00507-01521   |                   |                           |  | 3                                   | 0°16'                            | 0.33                   | 0.23                                      | 0.38                      | 15°                 | 4                       | 52                     | 36,500 |
| 01-00507-01530   | 1°                |                           | 2  | 0°46'                               | 0.35                             | 0.23                   | 0.38                                      | 15°                       | 4                   | 50                      | 36,000                 |        |
| 01-00507-01531   |                   |                           | 3  | 0°46'                               | 0.38                             | 0.23                   | 0.38                                      | 15°                       | 4                   | 52                      | 36,500                 |        |
| 01-00507-01540   | 1°30'             |                           | 2  | 1°16'                               | 0.39                             | 0.23                   | 0.38                                      | 15°                       | 4                   | 50                      | 36,000                 |        |
| 01-00507-01541   |                   |                           | 3  | 1°16'                               | 0.43                             | 0.23                   | 0.38                                      | 15°                       | 4                   | 52                      | 36,500                 |        |
| 01-00507-01550   | 2°                |                           | 2  | 1°46'                               | 0.42                             | 0.23                   | 0.38                                      | 15°                       | 4                   | 50                      | 36,000                 |        |
| 01-00507-01551   |                   |                           | 3  | 1°46'                               | 0.48                             | 0.23                   | 0.38                                      | 15°                       | 4                   | 52                      | 36,500                 |        |
| ★ 01-00507-02020 | R0.2              |                           | 30'                                      | 3                                   | 0°18'                            | 0.43                   | 0.3                                       | 0.5                       | 15°                 | 4                       | 50                     | 34,500 |
| ★ 01-00507-02021 |                   |                           |  | 4                                   | 0°18'                            | 0.44                   | 0.3                                       | 0.5                       | 15°                 | 4                       | 52                     | 35,000 |
| ★ 01-00507-02030 |                   | 1°                        | 3  | 0°48'                               | 0.48                             | 0.3                    | 0.5                                       | 15°                       | 4                   | 50                      | 34,500                 |        |
| ★ 01-00507-02031 |                   |                           | 4  | 0°48'                               | 0.51                             | 0.3                    | 0.5                                       | 15°                       | 4                   | 52                      | 35,000                 |        |
| ★ 01-00507-02040 |                   | 1°30'                     | 3  | 1°18'                               | 0.53                             | 0.3                    | 0.5                                       | 15°                       | 4                   | 50                      | 34,500                 |        |
| ★ 01-00507-02041 |                   |                           | 4  | 1°18'                               | 0.58                             | 0.3                    | 0.5                                       | 15°                       | 4                   | 52                      | 35,000                 |        |
| ★ 01-00507-02050 |                   | 2°                        | 3  | 1°48'                               | 0.58                             | 0.3                    | 0.5                                       | 15°                       | 4                   | 50                      | 34,500                 |        |
| ★ 01-00507-02051 |                   |                           | 4  | 1°48'                               | 0.64                             | 0.3                    | 0.5                                       | 15°                       | 4                   | 52                      | 35,000                 |        |

订购方法  
How to Order

请指定SSPBTN220 球头半径(R)×颈角(θ)×颈长(ℓ<sub>1</sub>)。  
When you order, indicate SSPBTN220 (R)×(θ)×(ℓ<sub>1</sub>).

※(γ)为参考值。  
※(γ) is reference value.



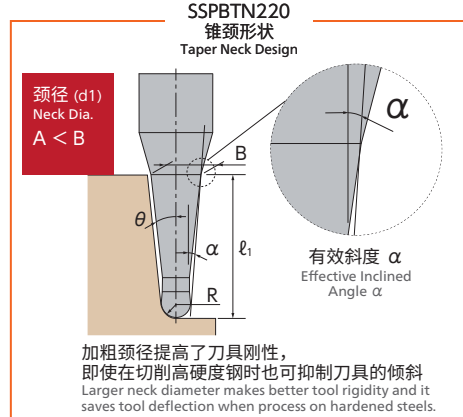
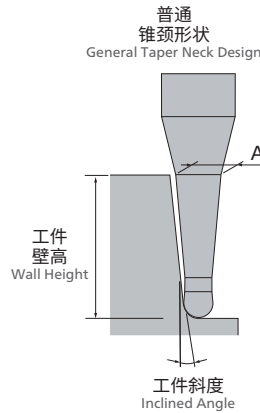

单位 [规格: mm / 价格: 日元]  
Unit [Size: mm / Retail Price: JPY]

| 产品代码<br>Code No. | (R)球头半径<br>Radius | (θ)颈角<br>Neck Taper Angle | (ℓ <sub>1</sub> )颈长<br>Under Neck Length | (α)有效斜度<br>Effective Inclined Angle | (d <sub>1</sub> )颈径<br>Neck Dia. | (ℓ)刃长<br>Length of Cut | (ℓ <sub>2</sub> )颈长<br>Under Neck Length <sub>2</sub> | (γ)颈角<br>Neck Taper Angle | (d)柄径<br>Shank Dia. | (L)全长<br>Overall Length | 定价(日元)<br>Retail Price |
|------------------|-------------------|---------------------------|--|-------------------------------------|----------------------------------|------------------------|---|---------------------------|---------------------|-------------------------|------------------------|
| ★ 01-00507-02520 | R0.25             | 30'                       | 4  | 0°18'                               | 0.54                             | 0.38                   | 0.62  | 15°                       | 4                   | 52                      | 33,500                 |
| ★ 01-00507-02521 |                   |                           | 5  | 0°18'                               | 0.55                             | 0.38                   | 0.62  | 15°                       | 4                   | 52                      | 34,000                 |
| ★ 01-00507-02530 |                   | 1°                        | 4  | 0°48'                               | 0.61                             | 0.38                   | 0.62  | 15°                       | 4                   | 52                      | 33,500                 |
| ★ 01-00507-02531 |                   |                           | 5  | 0°48'                               | 0.64                             | 0.38                   | 0.62  | 15°                       | 4                   | 52                      | 34,000                 |
| ★ 01-00507-02540 |                   | 1°30'                     | 4  | 1°18'                               | 0.67                             | 0.38                   | 0.62  | 15°                       | 4                   | 52                      | 33,500                 |
| ★ 01-00507-02541 |                   |                           | 5  | 1°18'                               | 0.72                             | 0.38                   | 0.62  | 15°                       | 4                   | 52                      | 34,000                 |
| ★ 01-00507-02550 | 2°                | 4                         | 1°48'                                    | 0.74                                | 0.38                             | 0.62                   | 15°   | 4                         | 52                  | 33,500                  |                        |
| ★ 01-00507-02551 |                   | 5                         | 1°48'                                    | 0.8                                 | 0.38                             | 0.62                   | 15°   | 4                         | 52                  | 34,000                  |                        |
| ★ 01-00507-03020 | R0.3              | 30'                       | 5  | 0°18'                               | 0.65                             | 0.5                    | 0.75  | 15°                       | 4                   | 53                      | 32,500                 |
| ★ 01-00507-03021 |                   |                           | 6  | 0°18'                               | 0.66                             | 0.5                    | 0.75  | 15°                       | 4                   | 53                      | 33,000                 |
| ★ 01-00507-03030 |                   | 1°                        | 5  | 0°48'                               | 0.74                             | 0.5                    | 0.75  | 15°                       | 4                   | 53                      | 32,500                 |
| ★ 01-00507-03031 |                   |                           | 6  | 0°48'                               | 0.76                             | 0.5                    | 0.75  | 15°                       | 4                   | 53                      | 33,000                 |
| ★ 01-00507-03040 |                   | 1°30'                     | 5  | 1°18'                               | 0.82                             | 0.5                    | 0.75  | 15°                       | 4                   | 53                      | 32,500                 |
| ★ 01-00507-03041 |                   |                           | 6  | 1°18'                               | 0.86                             | 0.5                    | 0.75  | 15°                       | 4                   | 53                      | 33,000                 |
| ★ 01-00507-03050 | 2°                | 5                         | 1°48'                                    | 0.9                                 | 0.5                              | 0.75                   | 15°   | 4                         | 53                  | 32,500                  |                        |
| ★ 01-00507-03051 |                   | 6                         | 1°48'                                    | 0.96                                | 0.5                              | 0.75                   | 15°   | 4                         | 53                  | 33,000                  |                        |
| ★ 01-00507-05020 | R0.5              | 30'                       | 8  | 0°21'                               | 1.1                              | 0.7                    | 1.25  | 15°                       | 4                   | 53                      | 32,000                 |
| ★ 01-00507-05021 |                   |                           | 10                                       | 0°21'                               | 1.12                             | 0.7                    | 1.25  | 15°                       | 4                   | 53                      | 32,500                 |
| ★ 01-00507-05030 |                   | 1°                        | 8  | 0°51'                               | 1.23                             | 0.7                    | 1.25  | 15°                       | 4                   | 53                      | 32,000                 |
| ★ 01-00507-05031 |                   |                           | 10                                       | 0°51'                               | 1.29                             | 0.7                    | 1.25  | 15°                       | 4                   | 53                      | 32,500                 |
| ★ 01-00507-05040 |                   | 1°30'                     | 8  | 1°21'                               | 1.36                             | 0.7                    | 1.25  | 15°                       | 4                   | 53                      | 32,000                 |
| ★ 01-00507-05041 |                   |                           | 10                                       | 1°21'                               | 1.45                             | 0.7                    | 1.25  | 15°                       | 4                   | 53                      | 32,500                 |
| ★ 01-00507-05050 | 2°                | 8                         | 1°51'                                    | 1.49                                | 0.7                              | 1.25                   | 15°   | 4                         | 53                  | 32,000                  |                        |
| ★ 01-00507-05051 |                   | 10                        | 1°51'                                    | 1.62                                | 0.7                              | 1.25                   | 15°   | 4                         | 53                  | 32,500                  |                        |
| ★ 01-00507-07520 | R0.75             | 30'                       | 10                                       | 0°22'                               | 1.62                             | 1                      | 1.9   | 15°                       | 4                   | 52                      | 33,500                 |
| ★ 01-00507-07521 |                   |                           | 15                                       | 0°22'                               | 1.69                             | 1                      | 1.9   | 15°                       | 4                   | 52                      | 34,000                 |
| ★ 01-00507-07530 |                   | 1°                        | 10                                       | 0°52'                               | 1.78                             | 1                      | 1.9   | 15°                       | 4                   | 52                      | 33,500                 |
| ★ 01-00507-07531 |                   |                           | 15                                       | 0°52'                               | 1.94                             | 1                      | 1.9   | 15°                       | 4                   | 52                      | 34,000                 |
| ★ 01-00507-07540 |                   | 1°30'                     | 10                                       | 1°22'                               | 1.95                             | 1                      | 1.9   | 15°                       | 4                   | 52                      | 33,500                 |
| ★ 01-00507-07541 |                   |                           | 15                                       | 1°22'                               | 2.18                             | 1                      | 1.9   | 15°                       | 4                   | 52                      | 34,000                 |
| ★ 01-00507-07550 | 2°                | 10                        | 1°52'                                    | 2.11                                | 1                                | 1.9                    | 15°   | 4                         | 52                  | 33,500                  |                        |
| ★ 01-00507-07551 |                   | 15                        | 1°52'                                    | 2.43                                | 1                                | 1.9                    | 15°   | 4                         | 52                  | 34,000                  |                        |
| ★ 01-00507-10020 | R1                | 30'                       | 16                                       | 0°24'                               | 2.21                             | 1.2                    | 2.5   | 15°                       | 4                   | 53                      | 33,500                 |
| ★ 01-00507-10021 |                   |                           | 20                                       | 0°24'                               | 2.27                             | 1.2                    | 2.5   | 15°                       | 4                   | 53                      | 34,000                 |
| ★ 01-00507-10030 |                   | 1°                        | 16                                       | 0°54'                               | 2.48                             | 1.2                    | 2.5   | 15°                       | 4                   | 53                      | 33,500                 |
| ★ 01-00507-10031 |                   |                           | 20                                       | 0°54'                               | 2.6                              | 1.2                    | 2.5   | 15°                       | 4                   | 53                      | 34,000                 |
| ★ 01-00507-10040 |                   | 1°30'                     | 16                                       | 1°24'                               | 2.74                             | 1.2                    | 2.5   | 15°                       | 4                   | 53                      | 33,500                 |
| ★ 01-00507-10041 |                   |                           | 20                                       | 1°24'                               | 2.93                             | 1.2                    | 2.5   | 15°                       | 4                   | 53                      | 34,000                 |
| ★ 01-00507-10050 | 2°                | 16                        | 1°54'                                    | 3                                   | 1.2                              | 2.5                    | 15°   | 4                         | 53                  | 33,500                  |                        |
| ★ 01-00507-10051 |                   | 20                        | 1°54'                                    | 3.26                                | 1.2                              | 2.5                    | 15°   | 4                         | 53                  | 34,000                  |                        |

锥颈  
Taper Neck

球头  
Ball

无涂层  
Non-Coating

H ~52高硬度钢  
HRC Hardened Steel

H ~60高硬度钢  
HRC Hardened Steel

H ~65高硬度钢  
HRC Hardened Steel

H ~70高硬度钢  
HRC Hardened Steel

CBN  
核心系列  
CBN  
Core Line