

无限白金Plus涂层高硬度钢材高精度加工用2刃长颈球头铣刀
可对应热缩刀柄的短柄造型

共有115种规格
Total 115 sizes

MUGEN COATING PREMIUM Plus 2-Flute Long Neck Ball End Mill with Short Shank for Hardened Steel and High Accuracy Cutting

对70HRC的高硬度钢材加工也可实现延长刀具寿命和高精度加工

High precision and long tool life even for hardened steels up to 70HRC

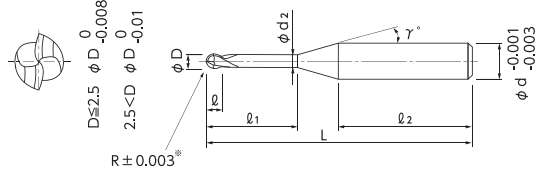

- 对70HRC的高硬度钢也可实现延长刀具寿命和稳定的切削性能。
- 新开发的无限白金Plus涂层提高了耐氧化性和耐磨损性。
- 采用耐崩损性更强的新材质和可减小切削阻力的刀刃设计。
- R精度达±0.003mm (R精度以实际外径的1/2为基准)。
- 柄径公差为-0.001mm至-0.003mm的高精度规格。
- Realize stable cutting performance even for 70 HRC hardened steels.
- Developed new MUGEN COATING PREMIUM Plus to upgrade oxidation resistance and abrasion resistance.
- Adopt optimized new tool material and tool design to reduce cutting load.
- R accuracy is ±0.003mm (R accuracy is based on a half value of actual diameter).
- Shank diameter tolerance, high accuracy type, is - 0.001mm / - 0.003mm.

※R精度以实际外径的1/2为基准
※ R accuracy is based on a half value of actual diameter

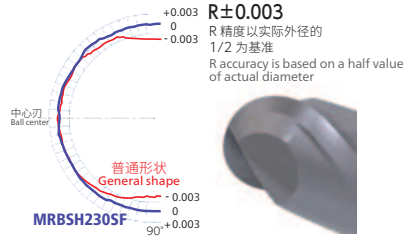

从R角到侧刃的接续位置, 刀面都采用无段差设计, 实现R精度的高精度化。
Seamless design on rake face and flank face from R-curve to peripheral cutting edge. Realized high precision R accuracy

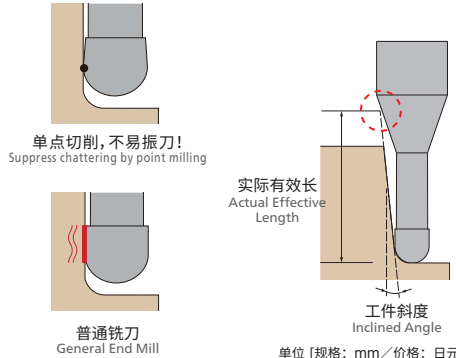

单位 [规格: mm / 价格: 日元]
Unit [Size: mm / Retail Price: JPY]

◆ 新增规格

产品代码 Code No.	(R)球头半径 Radius	(ℓ1)颈长 Under Neck Length	(ℓ)刃长 Length of Cut	(D)外径 Dia.	(d2)颈径 Neck Dia.	(γ)颈角 Neck Taper Angle	(d)柄径 Shank Dia.	(ℓ2)柄长 Shank Length	(L)全长 Overall Length	定价(日元) Retail Price	相对于工件斜度的有效长 Actual effective length depending on inclined angle of workpiece				
											30°	1°	1°30'	2°	3°
08-00537-00052	R0.05	0.2	0.07	0.1	0.085	15°	4	27.4	35	9,500	0.23	0.24	0.24	0.25	0.27
◆ 08-00537-00056		0.25	0.07	0.1	0.085	15°	4	27.4	35	9,500	0.28	0.29	0.30	0.31	0.33
08-00537-00053		0.3	0.07	0.1	0.085	15°	4	27.3	35	9,700	0.33	0.34	0.35	0.36	0.39
◆ 08-00537-00054		0.4	0.07	0.1	0.085	15°	4	27.2	35	9,700	0.44	0.45	0.46	0.48	0.52
08-00537-00055		0.5	0.07	0.1	0.085	15°	4	27.1	35	10,400	0.54	0.56	0.57	0.59	0.64
◆ 08-00537-00076	R0.075	0.25	0.1	0.15	0.13	15°	4	27.5	35	10,000	0.29	0.30	0.31	0.31	0.33
08-00537-00072		0.3	0.1	0.15	0.13	15°	4	27.4	35	10,000	0.34	0.35	0.36	0.37	0.40
◆ 08-00537-00077		0.4	0.1	0.15	0.13	15°	4	27.3	35	10,000	0.44	0.46	0.47	0.49	0.52
08-00537-00073		0.5	0.1	0.15	0.13	15°	4	27.2	35	10,400	0.55	0.56	0.58	0.60	0.65
◆ 08-00537-00074		0.6	0.1	0.15	0.13	15°	4	27.1	35	10,400	0.65	0.67	0.69	0.72	0.77
◆ 08-00537-00075	R0.1	0.7	0.1	0.15	0.13	15°	4	27.0	35	10,400	0.75	0.78	0.80	0.83	0.89
08-00537-00101		0.3	0.15	0.2	0.18	15°	4	27.5	35	7,600	0.34	0.35	0.36	0.37	0.39
◆ 08-00537-00106		0.4	0.15	0.2	0.18	15°	4	27.4	35	7,600	0.44	0.46	0.47	0.48	0.51
08-00537-00102		0.5	0.15	0.2	0.18	15°	4	27.3	35	7,600	0.55	0.56	0.58	0.60	0.64
◆ 08-00537-00107		0.6	0.15	0.2	0.18	15°	4	27.2	35	7,600	0.65	0.67	0.69	0.71	0.76
◆ 08-00537-00103	R0.15	0.75	0.15	0.2	0.18	15°	4	27.1	35	7,600	0.81	0.83	0.86	0.89	0.95
◆ 08-00537-00104		0.85	0.15	0.2	0.18	15°	4	27.0	35	7,600	0.91	0.94	0.97	1.00	1.07
08-00537-00105		1	0.15	0.2	0.18	15°	4	26.8	35	7,600	1.06	1.10	1.13	1.17	1.26
08-00537-00150		0.5	0.2	0.3	0.28	15°	4	27.5	35	7,500	0.55	0.56	0.57	0.59	0.63
08-00537-00151		0.6	0.2	0.3	0.28	15°	4	27.4	35	7,500	0.65	0.67	0.69	0.71	0.75
08-00537-00152	R0.15	0.75	0.2	0.3	0.28	15°	4	27.3	35	7,500	0.80	0.83	0.85	0.88	0.94
08-00537-00153		1	0.2	0.3	0.28	15°	4	27.0	35	7,500	1.06	1.09	1.13	1.17	1.25
◆ 08-00537-00154		1.25	0.2	0.3	0.28	15°	4	26.8	35	7,500	1.32	1.36	1.41	1.45	1.56
08-00537-00155	R0.15	1.5	0.2	0.3	0.28	15°	4	26.5	35	8,000	1.58	1.63	1.68	1.74	1.87

订购方法
How to Order

请指定MRBSH230SF 球头半径(R)×颈长(ℓ1)。
When you order, indicate MRBSH230SF (R)×(ℓ1).

※(γ)为参考值。
※(γ) is reference value.

加工案例
Machining Case

M-022, M-023

无限白金Plus涂层高硬度钢高精度加工用2刃长颈球头铣刀 可对应热缩刀柄的短柄造型

MUGEN COATING PREMIUM Plus 2-Flute Long Neck Ball End Mill with Short Shank for Hardened Steel and High Accuracy Cutting

◆ 新增加规格

单位 [规格: mm / 价格: 日元]
Unit [Size: mm / Retail Price: JPY]

产品代码 Code No.	(R)球头半径 Radius	(ℓ1)颈长 Under Neck Length	(ℓ)刃长 Length of Cut	(D)外径 Dia.	(d2)颈径 Neck Dia.	(γ)颈角 Neck Taper Angle	(d)柄径 Shank Dia.	(ℓ2)柄长 Shank Length	(L)全长 Overall Length	定价(日元) Retail Price	相对于工件斜度的有效长 Actual effective length depending on inclined angle of workpiece					
											30°	1°	1°30'	2°	3°	
08-00537-00201	R0.2	0.5	0.3	0.4	0.37	15°	4	27.7	35	5,500	0.56	0.58	0.59	0.60	0.64	
◆ 08-00537-00207		0.65	0.3	0.4	0.37	15°	4	27.6	35	5,500	0.72	0.74	0.76	0.78	0.83	
08-00537-00202		0.8	0.3	0.4	0.37	15°	4	27.4	35	5,500	0.87	0.90	0.92	0.95	1.01	
08-00537-00203		1	0.3	0.4	0.37	15°	4	27.2	35	5,500	1.08	1.11	1.14	1.18	1.26	
◆ 08-00537-00208		1.25	0.3	0.4	0.37	15°	4	27.0	35	5,700	1.34	1.38	1.42	1.47	1.57	
08-00537-00204		1.5	0.3	0.4	0.37	15°	4	26.7	35	5,700	1.60	1.65	1.70	1.75	1.88	
◆ 08-00537-00209		1.75	0.3	0.4	0.37	15°	4	26.5	35	5,800	1.86	1.91	1.98	2.04	2.19	
08-00537-00205		2	0.3	0.4	0.37	15°	4	26.2	35	5,800	2.11	2.18	2.25	2.33	2.50	
◆ 08-00537-00210		2.25	0.3	0.4	0.37	15°	4	26.0	35	6,000	2.37	2.45	2.53	2.62	2.81	
08-00537-00206		2.5	0.3	0.4	0.37	15°	4	25.7	35	6,000	2.63	2.72	2.81	2.90	3.13	
◆ 08-00537-00251	R0.25	0.5	0.35	0.5	0.46	15°	4	27.8	35	5,500	0.58	0.59	0.61	0.62	0.65	
08-00537-00252		1	0.35	0.5	0.46	15°	4	27.3	35	5,500	1.10	1.13	1.16	1.19	1.27	
08-00537-00253		1.5	0.35	0.5	0.46	15°	4	26.8	35	5,500	1.61	1.66	1.71	1.77	1.89	
08-00537-00254		2	0.35	0.5	0.46	15°	4	26.3	35	5,500	2.13	2.20	2.27	2.34	2.51	
08-00537-00255		2.5	0.35	0.5	0.46	15°	4	25.8	35	5,500	2.65	2.73	2.82	2.92	3.14	
08-00537-00256		3	0.35	0.5	0.46	15°	4	25.3	35	5,500	3.16	3.27	3.38	3.49	3.76	
◆ 08-00537-00307	R0.3	0.6	0.45	0.6	0.56	15°	4	27.9	35	4,700	0.68	0.70	0.71	0.73	0.76	
08-00537-00300		1	0.45	0.6	0.56	15°	4	27.5	35	4,700	1.10	1.12	1.15	1.19	1.26	
08-00537-00301		1.5	0.45	0.6	0.56	15°	4	27.0	35	4,300	1.61	1.66	1.71	1.76	1.88	
08-00537-00302		2	0.45	0.6	0.56	15°	4	26.5	35	4,300	2.13	2.19	2.26	2.34	2.50	
08-00537-00303		2.5	0.45	0.6	0.56	15°	4	26.0	35	4,400	2.65	2.73	2.82	2.91	3.12	
08-00537-00304		3	0.45	0.6	0.56	15°	4	25.5	35	4,400	3.16	3.26	3.37	3.49	3.75	
08-00537-00305		3.5	0.45	0.6	0.56	15°	4	25.0	35	4,500	3.68	3.80	3.92	4.06	4.37	
08-00537-00306		4	0.45	0.6	0.56	15°	4	29.5	40	4,500	4.20	4.33	4.48	4.64	4.99	
◆ 08-00537-00401		R0.4	1	0.6	0.8	0.76	15°	4	27.9	35	4,300	1.09	1.12	1.14	1.17	1.24
08-00537-00402			2	0.6	0.8	0.76	15°	4	26.9	35	4,300	2.13	2.19	2.25	2.32	2.48
08-00537-00403	3		0.6	0.8	0.76	15°	4	25.9	35	4,500	3.16	3.26	3.36	3.47	3.72	
08-00537-00405	4		0.6	0.8	0.76	15°	4	24.9	35	4,500	4.19	4.33	4.47	4.62	4.97	
08-00537-00406	5		0.6	0.8	0.76	15°	4	28.9	40	4,500	5.23	5.40	5.58	5.77	6.21	
◆ 08-00537-00507	R0.5		1	0.75	1	0.95	15°	4	28.3	35	3,700	1.11	1.13	1.15	1.18	1.24
◆ 08-00537-00508		1.5	0.75	1	0.95	15°	4	27.8	35	3,700	1.63	1.66	1.71	1.75	1.86	
08-00537-00501		2	0.75	1	0.95	15°	4	27.3	35	3,700	2.14	2.20	2.26	2.33	2.48	
08-00537-00502		2.5	0.75	1	0.95	15°	4	26.8	35	3,700	2.66	2.73	2.82	2.90	3.10	
08-00537-00503		3	0.75	1	0.95	15°	4	26.3	35	3,700	3.18	3.27	3.37	3.48	3.72	
08-00537-00504		4	0.75	1	0.95	15°	4	25.3	35	4,100	4.21	4.34	4.48	4.63	4.97	
08-00537-00505		5	0.75	1	0.95	15°	4	29.3	40	4,100	5.24	5.41	5.59	5.78	6.21	
08-00537-00506		6	0.75	1	0.95	15°	4	28.3	40	4,500	6.28	6.48	6.69	6.93	7.45	
08-00537-00602		R0.6	2.4	0.9	1.2	1.15	15°	4	27.2	35	5,400	2.55	2.62	2.69	2.77	2.95
08-00537-00603			4	0.9	1.2	1.15	15°	4	25.6	35	5,400	4.21	4.33	4.47	4.61	4.94
08-00537-00605	6		0.9	1.2	1.15	15°	4	28.6	40	5,900	6.27	6.47	6.68	6.91	7.43	
08-00537-00606	8		0.9	1.2	1.15	15°	4	26.6	40	5,900	8.34	8.61	8.90	9.21	9.91	
◆ 08-00537-00751	R0.75	2	1.1	1.5	1.45	15°	4	28.2	35	4,200	2.13	2.18	2.23	2.29	2.42	
08-00537-00752		3	1.1	1.5	1.45	15°	4	27.2	35	4,200	3.17	3.25	3.34	3.44	3.66	
08-00537-00753		4	1.1	1.5	1.45	15°	4	26.2	35	4,200	4.20	4.32	4.45	4.59	4.91	
08-00537-00754		6	1.1	1.5	1.45	15°	4	29.2	40	4,200	6.27	6.46	6.67	6.89	7.39	
08-00537-00755		8	1.1	1.5	1.45	15°	4	27.2	40	4,400	8.34	8.60	8.88	9.19	9.88	
08-00537-00756		10	1.1	1.5	1.45	15°	4	25.2	40	4,700	10.40	10.74	11.10	11.49	12.36	
08-00537-00805	R0.8	8	1.2	1.6	1.55	15°	4	27.4	40	5,900	8.33	8.60	8.88	9.18	9.87	
◆ 08-00537-00901	R0.9	3	1.3	1.8	1.74	15°	4	27.8	35	5,600	3.18	3.26	3.35	3.44	3.65	
◆ 08-00537-00902		4	1.3	1.8	1.74	15°	4	26.8	35	5,600	4.22	4.33	4.46	4.59	4.89	
◆ 08-00537-00903		6	1.3	1.8	1.74	15°	4	29.8	40	6,200	6.28	6.47	6.67	6.89	7.38	
◆ 08-00537-00904		8	1.3	1.8	1.74	15°	4	27.8	40	6,600	8.35	8.61	8.89	9.19	9.87	
◆ 08-00537-00905		10	1.3	1.8	1.74	15°	4	25.8	40	6,600	10.42	10.75	11.11	11.49	12.35	
◆ 08-00537-01006		2	1.5	2	1.94	15°	4	29.1	35	3,700	2.14	2.19	2.23	2.28	2.38	
08-00537-01000	R1	3	1.5	2	1.94	15°	4	28.1	35	3,700	3.18	3.25	3.34	3.43	3.63	
08-00537-01001		4	1.5	2	1.94	15°	4	27.1	35	3,700	4.21	4.32	4.45	4.58	4.87	
08-00537-01002		6	1.5	2	1.94	15°	4	25.1	35	4,100	6.28	6.46	6.66	6.88	7.36	
08-00537-01003		8	1.5	2	1.94	15°	4	28.1	40	4,400	8.35	8.60	8.88	9.18	9.84	
08-00537-01004		10	1.5	2	1.94	15°	4	26.1	40	4,400	10.41	10.74	11.10	11.48	12.33	
08-00537-01005		12	1.5	2	1.94	15°	4	29.1	45	4,400	12.48	12.88	13.31	13.77	14.82	



H ~65高硬度钢
HRC Hardened Steel

H ~70高硬度钢
HRC Hardened Steel

常规系列
无限白金Plus涂层
Regular Line
MUGEN PREMIUM Plus

无限白金Plus涂层高硬度钢材高精度加工用2刃长颈球头铣刀 可对应热缩刀柄的短柄造型

MUGEN COATING PREMIUM Plus 2-Flute Long Neck Ball End Mill with Short Shank for Hardened Steel and High Accuracy Cutting

单位 [规格: mm / 价格: 日元]
Unit [Size: mm / Retail Price: JPY]

◆ 新增加规格

产品代码 Code No.	(R)球头半径 Radius	(ℓ ₁)颈长 Under Neck Length	(ℓ)刃长 Length of Cut	(D)外径 Dia.	(d ₂)颈径 Neck Dia.	(γ)颈角 Neck Taper Angle	(d)柄径 Shank Dia.	(ℓ ₂)柄长 Shank Length	(L)全长 Overall Length	定价(日元) Retail Price	相对于工件斜度的有效长 Actual effective length depending on inclined angle of workpiece				
											30°	1°	1°30'	2°	3°
◆ 08-00537-01251	R1.25	4	2.3	2.5	2.4	15°	4	28.0	35	5,500	4.28	4.39	4.50	4.62	4.90
08-00537-01252		6	2.3	2.5	2.4	15°	4	26.0	35	5,500	6.35	6.53	6.72	6.92	7.39
08-00537-01253		8	2.3	2.5	2.4	15°	4	29.0	40	4,800	8.42	8.67	8.93	9.22	9.88
08-00537-01254		10	2.3	2.5	2.4	15°	4	27.0	40	5,800	10.48	10.81	11.15	11.52	12.36
08-00537-01256		15	2.3	2.5	2.4	15°	4	27.0	45	5,900	15.65	16.15	16.69	17.27	Free
08-00537-01500	R1.5	6	2.5	3	2.85	15°	6	33.1	45	4,600	6.44	6.61	6.79	7.00	7.45
08-00537-01501		8	2.5	3	2.85	15°	6	31.1	45	4,600	8.50	8.75	9.01	9.29	9.93
08-00537-01502		10	2.5	3	2.85	15°	6	29.1	45	5,300	10.57	10.89	11.23	11.59	12.42
08-00537-01503		12	2.5	3	2.85	15°	6	27.1	45	5,500	12.64	13.03	13.44	13.89	14.91
08-00537-01504		14	2.5	3	2.85	15°	6	30.1	50	6,200	14.71	15.17	15.66	16.19	17.39
08-00537-01505		16	2.5	3	2.85	15°	6	28.1	50	6,200	16.77	17.31	17.88	18.49	19.88
◆ 08-00537-01507		18	2.5	3	2.85	15°	6	31.1	55	6,200	18.84	19.45	20.09	20.79	22.36
08-00537-01506	20	2.5	3	2.85	15°	6	29.1	55	5,900	20.91	21.58	22.31	23.09	24.85	
08-00537-02000	R2	8	3	4	3.8	15°	6	32.8	45	4,700	8.58	8.81	9.06	9.33	9.93
08-00537-02001		10	3	4	3.8	15°	6	30.8	45	4,700	10.65	10.95	11.28	11.63	12.42
08-00537-02002		12	3	4	3.8	15°	6	28.8	45	6,200	12.72	13.09	13.49	13.93	14.90
08-00537-02004		15	3	4	3.8	15°	6	30.8	50	6,200	15.82	16.30	16.82	17.38	18.63
08-00537-02005		20	3	4	3.8	15°	6	30.8	55	6,200	20.99	21.65	22.36	23.13	Free
08-00537-02006	25	3	4	3.8	15°	6	30.8	60	6,200	26.16	27.00	27.90	28.88	Free	
08-00537-02502	R2.5	10	3.5	5	4.8	15°	6	32.7	45	7,200	10.63	10.92	11.22	11.55	Free
08-00537-02503		15	3.5	5	4.8	15°	6	27.7	45	9,900	15.80	16.27	16.77	Free	Free
08-00537-02504		20	3.5	5	4.8	15°	6	27.7	50	10,000	20.97	21.62	Free	Free	Free
◆ 08-00537-02505		25	3.5	5	4.8	15°	6	27.7	55	10,500	26.14	26.96	Free	Free	Free
◆ 08-00537-02506		30	3.5	5	4.8	15°	6	27.7	60	11,000	31.31	Free	Free	Free	Free
08-00537-03000	R3	10	6	6	5.7	—	6	34.4	45	7,700	Free	Free	Free	Free	Free
08-00537-03001		15	6	6	5.7	—	6	29.4	45	7,700	Free	Free	Free	Free	Free
08-00537-03002		20	6	6	5.7	—	6	29.4	50	7,700	Free	Free	Free	Free	Free
08-00537-03003		25	6	6	5.7	—	6	29.4	55	7,700	Free	Free	Free	Free	Free
08-00537-03004		30	6	6	5.7	—	6	29.4	60	7,900	Free	Free	Free	Free	Free
◆ 08-00537-03005		35	6	6	5.7	—	6	29.4	65	8,700	Free	Free	Free	Free	Free
◆ 08-00537-03006		40	6	6	5.7	—	6	29.4	70	9,200	Free	Free	Free	Free	Free

订购方法
How to Order

请指定MRBSH230SF 球头半径(R)×颈长(ℓ₁)。
When you order, indicate MRBSH230SF (R)×(ℓ₁).

※(γ)为参考值。
※(γ) is reference value.

加工案例
Machining Case

M-022, M-023

◎ 高硬度钢~65
Hardened Steel HRC H

◎ 高硬度钢~70
Hardened Steel HRC H

常规系列
无限白金Plus涂层
Regular Line
MUGEN PREMIUM Plus