

DHR237R

规格

Size $\phi 0.2 \times R0.02 \sim \phi 6 \times R1$

DLC

铜电极加工用长颈圆鼻铣刀

Long Neck Corner Radius End Mill for Copper Electrode

共有153种规格

Total 153 sizes

针对铜电极加工用的长颈圆鼻铣刀 刀刃锋利，可减少毛刺，实现优质的加工面

Long neck corner radius end mill specialized for machining copper alloy
Sharpe cutting edge makes less burr and high quality surface

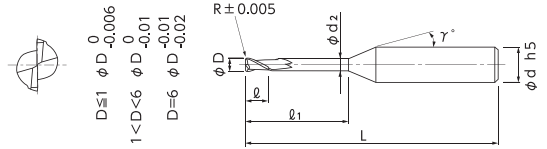
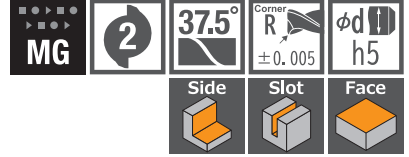

- 针对铜电极加工用的长颈圆鼻铣刀。
- 采用兼顾高锋利度、高品位加工表面的37.5°螺旋角和优化的刀刃形状，可提高加工面的品质。
- 采用DLC涂层，可确保长时间进行持续稳定的加工。
- 对钨铜电极的加工也很有效。
- Long neck radius end mill specialized for machining copper electrode.
- 37.5°helix angle provides both sharpness shearing ability and finishing surface quality, combining the most suitable cutting edge design realizes the higher quality of finishing surface.
- High quality and stable milling performance with long tool life by optimized design and DLC COATING.
- Machining copper tungsten electrodes is also effective.

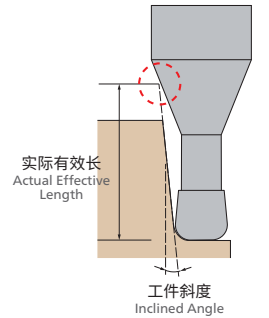

单位 [规格:mm / 价格:日元]
Unit [Size : mm / Retail Price : JPY]

产品代码 Code No.	(D)外径 Dia.	(R)角半径 Corner Radius	(l ₁)颈长 Under Neck Length	(l)刃长 Length of Cut	(d ₂)颈径 Neck Dia.	(γ)颈角 Neck Taper Angle	(d)柄径 Shank Dia.	(L)全长 Overall Length	定价(日元) Retail Price	相对于工件斜度的有效长 Actual effective length depending on inclined angle of workpiece				
										30°	1°	1°30'	2°	3°
07-00110-02021	0.2	R0.02	0.5	0.4	0.18	12°	4	45	11,500	0.56	0.59	0.62	0.65	0.71
07-00110-02023			1	0.4	0.18	12°	4	45	12,000	1.09	1.13	1.19	1.24	1.38
07-00110-02025			1.5	0.4	0.18	12°	4	45	12,300	1.61	1.68	1.76	1.84	2.04
07-00110-02051		R0.05	0.5	0.4	0.18	12°	4	45	11,500	0.56	0.59	0.61	0.64	0.71
07-00110-02053			1	0.4	0.18	12°	4	45	12,000	1.08	1.13	1.18	1.24	1.37
07-00110-02055			1.5	0.4	0.18	12°	4	45	12,300	1.61	1.68	1.75	1.84	2.03
07-00110-03021	0.3	R0.02	1	0.6	0.28	12°	4	45	12,000	1.09	1.13	1.19	1.24	1.38
07-00110-03022			1.5	0.6	0.28	12°	4	45	12,300	1.61	1.68	1.76	1.84	2.04
07-00110-03023			2	0.6	0.28	12°	4	45	12,500	2.13	2.22	2.33	2.44	2.71
07-00110-03051		R0.05	1	0.6	0.28	12°	4	45	12,000	1.08	1.13	1.18	1.24	1.37
07-00110-03052			1.5	0.6	0.28	12°	4	45	12,300	1.61	1.68	1.75	1.84	2.03
07-00110-03053			2	0.6	0.28	12°	4	45	12,500	2.13	2.22	2.32	2.43	2.70
07-00110-04021	0.4	R0.02	1	0.8	0.37	12°	4	45	10,500	1.11	1.16	1.21	1.27	1.41
07-00110-04023			2	0.8	0.37	12°	4	45	10,700	2.15	2.25	2.35	2.47	2.74
07-00110-04025			3	0.8	0.37	12°	4	45	10,900	3.20	3.34	3.49	3.67	4.06
07-00110-04027		R0.05	4	0.8	0.37	12°	4	45	11,100	4.24	4.43	4.63	4.86	5.39
07-00110-04051			1	0.8	0.37	12°	4	45	10,500	1.11	1.16	1.21	1.27	1.40
07-00110-04053			2	0.8	0.37	12°	4	45	10,700	2.15	2.25	2.35	2.46	2.73
07-00110-04055		R0.1	3	0.8	0.37	12°	4	45	10,900	3.19	3.34	3.49	3.66	4.05
07-00110-04057			4	0.8	0.37	12°	4	45	11,100	4.24	4.43	4.63	4.86	5.38
07-00110-04101			1	0.8	0.37	12°	4	45	10,500	1.11	1.15	1.20	1.26	1.38
07-00110-04103		R0.1	2	0.8	0.37	12°	4	45	10,700	2.15	2.24	2.34	2.45	2.71
07-00110-04105			3	0.8	0.37	12°	4	45	10,900	3.19	3.33	3.48	3.65	4.04
07-00110-04107			4	0.8	0.37	12°	4	45	11,100	4.24	4.42	4.62	4.85	5.37

订购方法
How to Order

请指定DHR237R 外径(D)×角半径(R)×颈长(l₁)。
When you order, indicate DHR237R (D)×(R)×(l₁).

※(γ)为参考值。

※(γ) is reference value.

加工案例
Machining case

M-038

圆鼻
Corner Radius
长颈
Long Neck
涂层
Coating

铝合金
Aluminium Alloy N
铜合金
Copper
钨铜
Copper Tungsten N
树脂
Resin O

铜电极加工
Copper Electrode
Milling

铜电极加工用长颈圆鼻铣刀

Long Neck Corner Radius End Mill for Copper Electrode

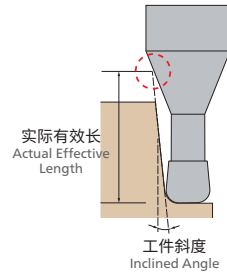

单位 [规格:mm / 价格:日元]
Unit [Size : mm / Retail Price : JPY]

产品代码 Code No.	(D)外径 Dia.	(R)角半径 Corner Radius	(ℓ ₁)颈长 Under Neck Length	(ℓ)刃长 Length of Cut	(d ₂)颈径 Neck Dia.	(γ)颈角 Neck Taper Angle	(d)柄径 Shank Dia.	(L)全长 Overall Length	定价(日元) Retail Price	相对于工件斜度的有效长 Actual effective length depending on inclined angle of workpiece					
										30°	1°	1°30'	2°	3°	
										07-00110-05022	0.5	R0.02	2	1	0.46
07-00110-05023	3	1	0.46	12°	4	45	10,600	3.22	3.36	3.52			3.69	4.10	
07-00110-05024	4	1	0.46	12°	4	45	10,800	4.26	4.45	4.66			4.89	5.42	
07-00110-05025	5	1	0.46	12°	4	45	11,000	5.31	5.54	5.80			6.09	6.75	
07-00110-05052	2	1	0.46	12°	4	45	10,400	2.18	2.27	2.38			2.49	2.76	
07-00110-05053	R0.05	3	1	0.46	12°	4	45	10,600	3.22	3.36		3.52	3.69	4.09	
07-00110-05054		4	1	0.46	12°	4	45	10,800	4.26	4.45		4.66	4.88	5.41	
07-00110-05055		5	1	0.46	12°	4	45	11,000	5.31	5.54		5.80	6.08	6.74	
07-00110-05102	R0.1	2	1	0.46	12°	4	45	10,400	2.17	2.27		2.37	2.48	2.74	
07-00110-05103		3	1	0.46	12°	4	45	10,600	3.22	3.36		3.51	3.68	4.07	
07-00110-05104		4	1	0.46	12°	4	45	10,800	4.26	4.45		4.65	4.87	5.40	
07-00110-05105		5	1	0.46	12°	4	45	11,000	5.30	5.54		5.79	6.07	6.72	
07-00110-06022	0.6	R0.02	2	1.2	0.56	12°	4	45	11,200	2.18		2.27	2.38	2.50	2.77
07-00110-06024			4	1.2	0.56	12°	4	45	11,700	4.26		4.45	4.66	4.89	5.42
07-00110-06026			6	1.2	0.56	12°	4	45	12,100	6.35		6.63	6.94	7.28	8.08
07-00110-06052		R0.05	2	1.2	0.56	12°	4	45	11,200	2.18	2.27	2.38	2.49	2.76	
07-00110-06054			4	1.2	0.56	12°	4	45	11,700	4.26	4.45	4.66	4.88	5.41	
07-00110-06056			6	1.2	0.56	12°	4	45	12,100	6.35	6.63	6.94	7.28	8.07	
07-00110-06102		R0.1	2	1.2	0.56	12°	4	45	11,200	2.17	2.27	2.37	2.48	2.74	
07-00110-06104			4	1.2	0.56	12°	4	45	11,700	4.26	4.45	4.65	4.87	5.40	
07-00110-06106			6	1.2	0.56	12°	4	45	12,100	6.35	6.63	6.93	7.27	8.05	
07-00110-08024		0.8	R0.02	4	1.6	0.76	12°	4	45	11,700	4.26	4.45	4.66	4.89	5.42
07-00110-08026				6	1.6	0.76	12°	4	45	12,100	6.35	6.63	6.94	7.28	8.08
07-00110-08028				8	1.6	0.76	12°	4	50	12,300	8.43	8.81	9.22	9.68	10.73
07-00110-08054			R0.05	4	1.6	0.76	12°	4	45	11,700	4.26	4.45	4.66	4.88	5.41
07-00110-08056				6	1.6	0.76	12°	4	45	12,100	6.35	6.63	6.94	7.28	8.07
07-00110-08058				8	1.6	0.76	12°	4	50	12,300	8.43	8.81	9.22	9.67	10.72
07-00110-08104	R0.1		4	1.6	0.76	12°	4	45	11,700	4.26	4.45	4.65	4.87	5.40	
07-00110-08106			6	1.6	0.76	12°	4	45	12,100	6.35	6.63	6.93	7.27	8.05	
07-00110-08108			8	1.6	0.76	12°	4	50	12,300	8.43	8.80	9.21	9.66	10.71	
07-00110-10053	1		R0.05	3	2	0.95	12°	4	45	10,900	3.24	3.39	3.54	3.72	4.12
07-00110-10054				4	2	0.95	12°	4	45	11,000	4.29	4.48	4.68	4.91	5.44
07-00110-10055				5	2	0.95	12°	4	45	11,300	5.33	5.57	5.82	6.11	6.77
07-00110-10056				6	2	0.95	12°	4	45	11,500	6.37	6.66	6.97	7.31	8.10
07-00110-10058				8	2	0.95	12°	4	50	11,700	8.46	8.83	9.25	9.70	10.75
07-00110-10060			10	2	0.95	12°	4	50	12,000	10.54	11.01	11.53	12.09	13.41	
07-00110-10103		R0.1	3	2	0.95	12°	4	45	10,900	3.24	3.38	3.54	3.71	4.10	
07-00110-10104			4	2	0.95	12°	4	45	11,000	4.28	4.47	4.68	4.90	5.43	
07-00110-10105			5	2	0.95	12°	4	45	11,300	5.33	5.56	5.82	6.10	6.76	
07-00110-10106			6	2	0.95	12°	4	45	11,500	6.37	6.65	6.96	7.30	8.08	
07-00110-10108			8	2	0.95	12°	4	50	11,700	8.46	8.83	9.24	9.69	10.74	
07-00110-10110		10	2	0.95	12°	4	50	12,000	10.54	11.01	11.52	12.08	13.39		
07-00110-10203		R0.2	3	2	0.95	12°	4	45	10,900	3.24	3.37	3.52	3.69	4.07	
07-00110-10204			4	2	0.95	12°	4	45	11,000	4.28	4.46	4.66	4.88	5.40	
07-00110-10205			5	2	0.95	12°	4	45	11,300	5.32	5.55	5.80	6.08	6.72	
07-00110-10206	6		2	0.95	12°	4	45	11,500	6.37	6.64	6.94	7.28	8.05		
07-00110-10208	8		2	0.95	12°	4	50	11,700	8.45	8.82	9.23	9.67	10.71		
07-00110-10210	10	2	0.95	12°	4	50	12,000	10.54	11.00	11.51	12.06	13.36			

长颈
Long Neck

圆鼻
Corner Radius



涂层
Coating

Corner Radius

N 铝合金
Aluminium Alloy

N 铜合金
Copper
钨铜
Copper Tungsten

O 树脂
Resin

铜电极加工
Copper Electrode
Milling

DHR237R

铜电极加工用长颈圆鼻铣刀

Long Neck Corner Radius End Mill for Copper Electrode

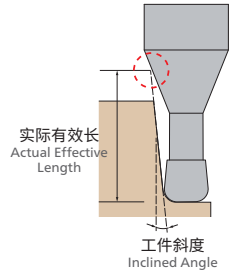

单位 [规格:mm / 价格:日元]
Unit [Size : mm / Retail Price : JPY]

产品代码 Code No.	(D)外径 Dia.	(R)角半径 Corner Radius	(ℓ ₁)颈长 Under Neck Length	(ℓ)刃长 Length of Cut	(d ₂)颈径 Neck Dia.	(γ)颈角 Neck Taper Angle	(d)柄径 Shank Dia.	(L)全长 Overall Length	定价(日元) Retail Price	相对于工件斜度的有效长 Actual effective length depending on inclined angle of workpiece				
										30°	1°	1°30'	2°	3°
07-00110-15105	1.5	R0.1	5	3	1.45	12°	4	45	11,400	5.33	5.56	5.82	6.10	6.76
07-00110-15110			10	3	1.45	12°	4	50	11,500	10.54	11.01	11.52	12.08	13.39
07-00110-15115			15	3	1.45	12°	4	50	11,600	15.76	16.46	17.22	18.07	20.03
07-00110-15205		R0.2	5	3	1.45	12°	4	45	11,400	5.32	5.55	5.80	6.08	6.72
07-00110-15210			10	3	1.45	12°	4	50	11,500	10.54	11.00	11.51	12.06	13.36
07-00110-15215			15	3	1.45	12°	4	50	11,600	15.75	16.45	17.21	18.05	20.00
07-00110-15305		R0.3	5	3	1.45	12°	4	45	10,900	5.32	5.54	5.79	6.06	6.69
07-00110-15310			10	3	1.45	12°	4	50	11,500	10.53	10.99	11.49	12.04	13.33
07-00110-15315			15	3	1.45	12°	4	50	11,600	15.75	16.44	17.20	18.03	19.96
07-00110-15505		R0.5	5	3	1.45	12°	4	45	11,000	5.31	5.53	5.76	6.02	6.63
07-00110-15510			10	3	1.45	12°	4	50	11,500	10.52	10.97	11.46	12.01	13.26
07-00110-15515			15	3	1.45	12°	4	50	11,600	15.74	16.42	17.17	17.99	19.90
07-00110-15520			20	3	1.45	12°	4	60	11,800	20.95	21.87	22.87	23.97	Free
07-00110-20105	2	R0.1	5	4	1.94	12°	4	45	10,600	5.35	5.59	5.84	6.13	6.79
07-00110-20108			8	4	1.94	12°	4	50	11,000	8.48	8.86	9.27	9.72	10.77
07-00110-20110			10	4	1.94	12°	4	50	11,100	10.57	11.03	11.55	12.11	13.42
07-00110-20115			15	4	1.94	12°	4	50	11,200	15.78	16.48	17.25	18.09	Free
07-00110-20120			20	4	1.94	12°	4	60	11,400	20.99	21.93	22.95	24.08	Free
07-00110-20205		R0.2	5	4	1.94	12°	4	45	10,600	5.35	5.58	5.83	6.11	6.75
07-00110-20208			8	4	1.94	12°	4	50	11,000	8.48	8.85	9.25	9.70	10.74
07-00110-20210			10	4	1.94	12°	4	50	11,100	10.56	11.03	11.53	12.09	13.39
07-00110-20215			15	4	1.94	12°	4	50	11,200	15.78	16.47	17.24	18.07	Free
07-00110-20220			20	4	1.94	12°	4	60	11,400	20.99	21.92	22.94	24.06	Free
07-00110-20305		R0.3	5	4	1.94	12°	4	45	10,600	5.34	5.57	5.82	6.09	6.72
07-00110-20308			8	4	1.94	12°	4	50	11,000	8.47	8.84	9.24	9.68	10.70
07-00110-20310	10		4	1.94	12°	4	50	11,100	10.56	11.02	11.52	12.07	13.36	
07-00110-20315	15		4	1.94	12°	4	50	11,200	15.77	16.46	17.22	18.05	Free	
07-00110-20320	20		4	1.94	12°	4	60	11,400	20.99	21.91	22.92	24.04	Free	
07-00110-20505	R0.5	5	4	1.94	12°	4	45	10,600	5.33	5.55	5.79	6.05	6.66	
07-00110-20508		8	4	1.94	12°	4	50	11,000	8.46	8.82	9.21	9.64	10.64	
07-00110-20510		10	4	1.94	12°	4	50	11,100	10.55	11.00	11.49	12.03	13.30	
07-00110-20515		15	4	1.94	12°	4	50	11,200	15.76	16.45	17.19	18.02	Free	
07-00110-20520		20	4	1.94	12°	4	60	11,400	20.98	21.89	22.90	24.00	Free	
07-00110-25208	2.5	R0.2	8	5	2.4	12°	4	50	11,000	8.57	8.95	9.36	9.81	10.86
07-00110-25214			14	5	2.4	12°	4	50	11,200	14.83	15.49	16.20	16.99	Free
07-00110-25220			20	5	2.4	12°	4	60	11,400	21.09	22.02	23.05	Free	Free
07-00110-25508		R0.5	8	5	2.4	12°	4	50	11,000	8.56	8.92	9.32	9.75	10.77
07-00110-25514			14	5	2.4	12°	4	50	11,200	14.82	15.46	16.16	16.93	Free
07-00110-25520			20	5	2.4	12°	4	60	11,400	21.08	22.00	23.00	Free	Free

订购方法 How to Order

请指定DHR237R 外径(D)×角半径(R)×颈长(ℓ₁)。
When you order, indicate DHR237R (D)×(R)×(ℓ₁).

※(γ)为参考值。

※(γ) is reference value.

加工案例 Machining case

M-038

铜电极加工

Copper Electrode
Milling

铜电极加工用长颈圆鼻铣刀

Long Neck Corner Radius End Mill for Copper Electrode

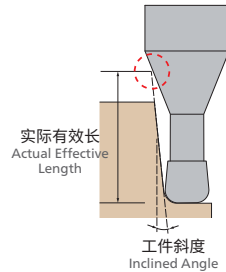

单位 [规格: mm / 价格: 日元]
Unit [Size : mm / Retail Price : JPY]

产品代码 Code No.	(D)外径 Dia.	(R)角半径 Corner Radius	(ℓ ₁)颈长 Under Neck Length	(ℓ)刃长 Length of Cut	(d ₂)颈径 Neck Dia.	(γ)颈角 Neck Taper Angle	(d)柄径 Shank Dia.	(L)全长 Overall Length	定价(日元) Retail Price	相对于工件斜度的有效长 Actual effective length depending on inclined angle of workpiece				
										30°	1°	1°30'	2°	3°
										07-00110-30112	3	R0.1	12	6
07-00110-30118	18	6	2.85	12°	6	60	12,300	19.13	19.98	20.91			21.94	24.32
07-00110-30124	24	6	2.85	12°	6	70	13,000	25.39	26.52	27.76			29.12	Free
07-00110-30212	R0.2	12	6	2.85	12°	6	50	12,000	12.87	13.44		14.06	14.74	16.33
07-00110-30218		18	6	2.85	12°	6	60	12,300	19.13	19.97		20.90	21.92	24.29
07-00110-30224		24	6	2.85	12°	6	70	13,000	25.38	26.51		27.74	29.10	Free
07-00110-30312	R0.3	12	6	2.85	12°	6	50	12,000	12.86	13.43		14.04	14.72	16.29
07-00110-30318		18	6	2.85	12°	6	60	12,300	19.12	19.96		20.88	21.90	24.26
07-00110-30324		24	6	2.85	12°	6	70	13,000	25.38	26.50		27.73	29.08	Free
07-00110-30512	R0.5	12	6	2.85	12°	6	50	12,000	12.86	13.41		14.01	14.68	16.23
07-00110-30515		15	6	2.85	12°	6	60	12,200	15.98	16.68		17.44	18.27	20.21
07-00110-30518		18	6	2.85	12°	6	60	12,300	19.11	19.95		20.86	21.86	24.19
07-00110-30524		24	6	2.85	12°	6	70	13,800	25.37	26.48		27.70	29.04	Free
07-00110-30530		30	6	2.85	12°	6	70	14,200	31.63	33.02		34.54	36.22	Free
07-00110-40116	4	R0.1	16	8	3.8	12°	6	60	12,000	17.17		17.93	18.77	19.68
07-00110-40124			24	8	3.8	12°	6	60	12,300	25.51	26.65	27.89	Free	Free
07-00110-40132			32	8	3.8	12°	6	70	13,000	33.85	35.36	37.01	Free	Free
07-00110-40216		R0.2	16	8	3.8	12°	6	60	12,000	17.16	17.92	18.75	19.66	Free
07-00110-40224			24	8	3.8	12°	6	60	12,300	25.50	26.64	27.88	Free	Free
07-00110-40232			32	8	3.8	12°	6	70	13,000	33.85	35.35	37.00	Free	Free
07-00110-40316		R0.3	16	8	3.8	12°	6	60	12,000	17.16	17.91	18.74	19.65	Free
07-00110-40324			24	8	3.8	12°	6	60	12,300	25.50	26.63	27.86	Free	Free
07-00110-40332			32	8	3.8	12°	6	70	13,000	33.84	35.34	36.99	Free	Free
07-00110-40516		R0.5	16	8	3.8	12°	6	60	12,000	17.15	17.89	18.71	19.61	Free
07-00110-40524			24	8	3.8	12°	6	60	12,300	25.49	26.61	27.83	Free	Free
07-00110-40532			32	8	3.8	12°	6	70	13,800	33.83	35.33	36.96	Free	Free
07-00110-41016		R1	16	8	3.8	12°	6	60	12,000	17.13	17.85	18.64	19.51	Free
07-00110-41024			24	8	3.8	12°	6	60	12,300	25.47	26.57	27.77	29.08	Free
07-00110-41032			32	8	3.8	12°	6	70	13,800	33.81	35.28	36.89	Free	Free
07-00110-50120	5	R0.1	20	10	4.8	12°	6	60	12,200	21.34	22.29	Free	Free	Free
07-00110-50140			40	10	4.8	12°	6	80	17,800	42.19	Free	Free	Free	Free
07-00110-60124		6	R0.1	24	12	5.8	-	6	60	13,800	Free	Free	Free	Free
07-00110-60148	48			12	5.8	-	6	90	21,600	Free	Free	Free	Free	Free
07-00110-60224	R0.2		24	12	5.8	-	6	60	13,800	Free	Free	Free	Free	Free
07-00110-60248			48	12	5.8	-	6	90	21,600	Free	Free	Free	Free	Free
07-00110-60324	R0.3		24	12	5.8	-	6	60	13,800	Free	Free	Free	Free	Free
07-00110-60348			48	12	5.8	-	6	90	21,600	Free	Free	Free	Free	Free
07-00110-60524	R0.5		24	12	5.8	-	6	60	13,800	Free	Free	Free	Free	Free
07-00110-60530			30	12	5.8	-	6	70	14,500	Free	Free	Free	Free	Free
07-00110-60548			48	12	5.8	-	6	90	21,600	Free	Free	Free	Free	Free
07-00110-61024	R1		24	12	5.8	-	6	60	13,800	Free	Free	Free	Free	Free
07-00110-61048			48	12	5.8	-	6	90	21,600	Free	Free	Free	Free	Free

长颈
Long Neck

圆鼻
Corner Radius

涂层
Coating

N 铝合金
Aluminium Alloy

N 铜合金
Copper
钨铜
Copper-Tungsten

O 树脂
Resin

铜电极加工
Copper Electrode
Milling