

铜电极加工用长颈球头铣刀
Long Neck Ball End Mill for Copper Electrode

共 94 种规格

Total 94 sizes

针对铜电极加工特别研发的长颈球头铣刀，
锋利的刃口能有效抑制毛刺，实现良好的加工面

Long neck ball end mill specialized for machining copper alloy.
Sharpe cutting edge makes less burr and high quality surface.

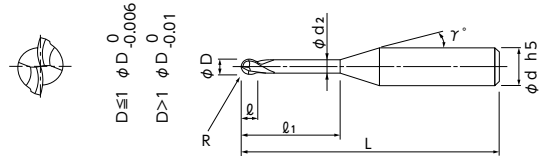

R ≤ 0.2 R ± 0.002
0.2 < R ≤ 0.5 R ± 0.003
R > 0.5 R ± 0.004

※ DRB230 的 R 角精度以实际刃径的 1/2 为基准精度。
R accuracy of DRB230 is based on a half value of φD.

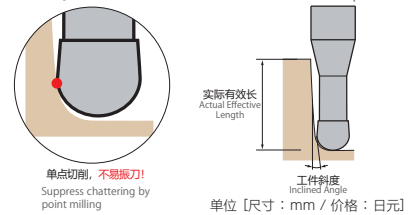

单位 [尺寸 : mm / 价格 : 日元]
Unit [Size : mm / Retail price : JPY]

- 针对铜电极加工特别研发的长颈球头铣刀。
- 锋利的刃口形状和全新的 DLC 涂层实现了长时间安定的高品质加工。
- 也可有效加工钨铜电极。
- Long neck ball end mill specialized for machining copper electrode.
- Sharp edge shearing ability and DLC coating realized high quality and stable a long life machining.
- Machining copper tungsten electrodes is also effective.

加工材料 Work material

铜 Copper	钨铜 Copper tungsten
◎	◎

产品代码 Code No.	(R)球头半径 Radius	(ℓ ₁)颈长 Under neck length	(ℓ)刃长 Length of cut	(D)刃径 Dia.	(d ₂)颈径 Neck Dia.	(γ)颈角 Neck taper angle	(d)柄径 Shank Dia.	(L)全长 Overall length	标准价格 Retail price	相对于工件斜度的有效长 Actual effective length depending on inclined angle of workpiece.				
										30°	1°	1°30'	2°	3°
07-00530-00503	R0.05	0.3	0.07	0.1	0.085	12°	4	45	13,900	0.34	0.36	0.37	0.39	0.42
07-00530-00505		0.5	0.07	0.1	0.085	12°	4	45	14,500	0.55	0.57	0.60	0.63	0.69
07-00530-00703	R0.075	0.3	0.1	0.15	0.13	12°	4	45	14,000	0.35	0.37	0.38	0.40	0.43
07-00530-00705		0.5	0.1	0.15	0.13	12°	4	45	14,400	0.56	0.58	0.61	0.64	0.70
07-00530-00710		1	0.1	0.15	0.13	12°	4	45	15,000	1.08	1.13	1.18	1.23	1.36
07-00530-01005	R0.1	0.5	0.15	0.2	0.18	12°	4	45	11,100	0.56	0.58	0.61	0.63	0.69
07-00530-01007		0.75	0.15	0.2	0.18	12°	4	45	11,400	0.82	0.85	0.89	0.93	1.02
07-00530-01010		1	0.15	0.2	0.18	12°	4	45	11,600	1.08	1.13	1.18	1.23	1.35
07-00530-01015		1.5	0.15	0.2	0.18	12°	4	45	12,100	1.60	1.67	1.75	1.83	2.02
07-00530-01020		2	0.15	0.2	0.18	12°	4	45	12,600	2.13	2.22	2.32	2.43	2.68
07-00530-01505	R0.15	0.5	0.2	0.3	0.28	12°	4	45	11,100	0.56	0.58	0.60	0.62	0.67
07-00530-01510		1	0.2	0.3	0.28	12°	4	45	11,600	1.08	1.12	1.17	1.22	1.34
07-00530-01515		1.5	0.2	0.3	0.28	12°	4	45	12,100	1.60	1.67	1.74	1.82	2.00
07-00530-01520		2	0.2	0.3	0.28	12°	4	45	12,600	2.12	2.21	2.31	2.42	2.66
07-00530-02005		R0.2	0.5	0.3	0.4	0.37	12°	4	45	10,100	0.58	0.60	0.62	0.64
07-00530-02010	1		0.3	0.4	0.37	12°	4	45	10,100	1.10	1.14	1.19	1.24	1.35
07-00530-02015	1.5		0.3	0.4	0.37	12°	4	45	10,300	1.62	1.69	1.76	1.84	2.02
07-00530-02020	2		0.3	0.4	0.37	12°	4	45	10,300	2.15	2.23	2.33	2.43	2.68
07-00530-02030	3		0.3	0.4	0.37	12°	4	45	10,500	3.19	3.32	3.47	3.63	4.01
07-00530-02040	4		0.3	0.4	0.37	12°	4	45	10,700	4.23	4.41	4.61	4.83	5.33
07-00530-02050	5		0.3	0.4	0.37	12°	4	45	10,900	5.27	5.50	5.75	6.02	6.66
07-00530-02060	6		0.3	0.4	0.37	12°	4	45	11,100	6.32	6.59	6.89	7.22	7.99
07-00530-02510	R0.25	1	0.35	0.5	0.46	12°	4	45	9,800	1.13	1.16	1.21	1.26	1.37
07-00530-02515		1.5	0.35	0.5	0.46	12°	4	45	9,800	1.65	1.71	1.78	1.85	2.03
07-00530-02520		2	0.35	0.5	0.46	12°	4	45	9,900	2.17	2.25	2.35	2.45	2.69
07-00530-02530		3	0.35	0.5	0.46	12°	4	45	10,100	3.21	3.34	3.49	3.65	4.02
07-00530-02540		4	0.35	0.5	0.46	12°	4	45	10,300	4.25	4.43	4.63	4.85	5.35
07-00530-02550		5	0.35	0.5	0.46	12°	4	45	10,500	5.30	5.52	5.77	6.04	6.68
07-00530-02560		6	0.35	0.5	0.46	12°	4	45	10,700	6.34	6.61	6.91	7.24	8.00
07-00530-03010	R0.3	1	0.45	0.6	0.56	12°	4	45	7,500	1.12	1.16	1.20	1.25	1.35
07-00530-03015		1.5	0.45	0.6	0.56	12°	4	45	7,700	1.64	1.71	1.77	1.84	2.02
07-00530-03020		2	0.45	0.6	0.56	12°	4	45	7,700	2.17	2.25	2.34	2.44	2.68
07-00530-03030		3	0.45	0.6	0.56	12°	4	45	7,900	3.21	3.34	3.48	3.64	4.01
07-00530-03040		4	0.45	0.6	0.56	12°	4	45	8,100	4.25	4.43	4.62	4.84	5.33
07-00530-03050		5	0.45	0.6	0.56	12°	4	45	8,300	5.29	5.52	5.76	6.03	6.66
07-00530-03060		6	0.45	0.6	0.56	12°	4	45	8,500	6.34	6.61	6.90	7.23	7.99
07-00530-03080		8	0.45	0.6	0.56	12°	4	45	9,000	8.42	8.79	9.18	9.62	10.64
07-00530-03100	10	0.45	0.6	0.56	12°	4	50	9,500	10.51	10.97	11.47	12.02	13.30	

订购方式

请指定DRB230 球头半径(R) × 颈长(ℓ₁)。
When you order, indicate DRB230 (R) × (ℓ₁).

※(γ)为参考值。
※(γ) is reference value.

产品代码 Code No.	(R)球头半径 Radius	(D1)颈长 Under neck length	(L)刃长 Length of cut	(D)刃径 Dia.	(d2)颈径 Neck Dia.	(γ)颈角 Neck taper angle	(d)柄径 Shank Dia.	(L)全长 Overall length	标准价格 Retail price	相对于工件斜度的有效长 Actual effective length depending on inclined angle of workpiece.				
										30°	1°	1°30′	2°	3°
07-00530-04015	R0.4	1.5	0.6	0.8	0.76	12°	4	45	7,700	1.64	1.70	1.76	1.83	1.98
07-00530-04020		2	0.6	0.8	0.76	12°	4	45	7,700	2.16	2.24	2.33	2.42	2.65
07-00530-04030		3	0.6	0.8	0.76	12°	4	45	7,900	3.20	3.33	3.47	3.62	3.97
07-00530-04040		4	0.6	0.8	0.76	12°	4	45	8,100	4.25	4.42	4.61	4.82	5.30
07-00530-04050		5	0.6	0.8	0.76	12°	4	45	8,300	5.29	5.51	5.75	6.01	6.63
07-00530-04060		6	0.6	0.8	0.76	12°	4	45	8,300	6.33	6.60	6.89	7.21	7.96
07-00530-04080		8	0.6	0.8	0.76	12°	4	45	8,500	8.42	8.78	9.17	9.60	10.61
07-00530-04100		10	0.6	0.8	0.76	12°	4	50	9,000	10.50	10.96	11.45	12.00	13.26
07-00530-05020	R0.5	2	0.75	1	0.95	12°	4	45	7,400	2.18	2.26	2.34	2.43	2.65
07-00530-05030		3	0.75	1	0.95	12°	4	45	7,500	3.22	3.35	3.48	3.63	3.97
07-00530-05040		4	0.75	1	0.95	12°	4	45	7,500	4.27	4.44	4.62	4.83	5.30
07-00530-05050		5	0.75	1	0.95	12°	4	45	7,700	5.31	5.53	5.76	6.02	6.63
07-00530-05060		6	0.75	1	0.95	12°	4	45	7,700	6.35	6.62	6.90	7.22	7.96
07-00530-05080		8	0.75	1	0.95	12°	4	45	8,100	8.44	8.79	9.18	9.61	10.61
07-00530-05100		10	0.75	1	0.95	12°	4	45	8,100	10.52	10.97	11.46	12.01	13.26
07-00530-05120		12	0.75	1	0.95	12°	4	45	8,100	12.61	13.15	13.75	14.40	15.92
07-00530-05140		14	0.75	1	0.95	12°	4	50	8,500	14.70	15.33	16.03	16.79	18.57
07-00530-05160		16	0.75	1	0.95	12°	4	50	8,500	16.78	17.51	18.31	19.18	21.23
07-00530-07504	R0.75	4	1.1	1.5	1.45	12°	4	50	7,700	4.26	4.41	4.59	4.78	5.22
07-00530-07506		6	1.1	1.5	1.45	12°	4	50	7,700	6.34	6.59	6.87	7.17	7.88
07-00530-07508		8	1.1	1.5	1.45	12°	4	50	8,300	8.43	8.77	9.15	9.56	10.53
07-00530-07510		10	1.1	1.5	1.45	12°	4	50	8,300	10.51	10.95	11.43	11.96	13.18
07-00530-07512		12	1.1	1.5	1.45	12°	4	50	8,700	12.60	13.13	13.71	14.35	15.84
07-00530-07514		14	1.1	1.5	1.45	12°	4	50	8,700	14.69	15.31	15.99	16.74	18.49
07-00530-07516		16	1.1	1.5	1.45	12°	4	50	9,300	16.77	17.49	18.27	19.14	21.15
07-00530-07518		18	1.1	1.5	1.45	12°	4	50	9,700	18.86	19.67	20.55	21.53	23.80
07-00530-10030	R1	3	1.5	2	1.94	12°	4	50	7,900	3.23	3.33	3.44	3.56	3.85
07-00530-10040		4	1.5	2	1.94	12°	4	50	7,900	4.27	4.42	4.58	4.76	5.17
07-00530-10060		6	1.5	2	1.94	12°	4	50	7,900	6.36	6.60	6.86	7.15	7.83
07-00530-10080		8	1.5	2	1.94	12°	4	50	8,100	8.44	8.78	9.14	9.54	10.48
07-00530-10100		10	1.5	2	1.94	12°	4	50	8,100	10.53	10.95	11.42	11.94	13.14
07-00530-10120		12	1.5	2	1.94	12°	4	50	8,100	12.61	13.13	13.70	14.33	15.79
07-00530-10140		14	1.5	2	1.94	12°	4	50	8,100	14.70	15.31	15.98	16.72	18.45
07-00530-10160		16	1.5	2	1.94	12°	4	50	8,100	16.78	17.49	18.27	19.12	Free
07-00530-10200		20	1.5	2	1.94	12°	4	60	9,000	20.96	21.85	22.83	23.90	Free
07-00530-10250		25	1.5	2	1.94	12°	4	60	10,000	26.17	27.30	28.53	Free	Free
07-00530-15060	R1.5	6	2.5	3	2.85	12°	6	60	10,000	6.56	6.78	7.03	7.31	7.95
07-00530-15080		8	2.5	3	2.85	12°	6	60	10,300	8.64	8.96	9.31	9.70	10.60
07-00530-15100		10	2.5	3	2.85	12°	6	60	10,300	10.73	11.14	11.59	12.09	13.26
07-00530-15120		12	2.5	3	2.85	12°	6	60	10,300	12.81	13.32	13.88	14.49	15.91
07-00530-15150		15	2.5	3	2.85	12°	6	70	10,500	15.94	16.59	17.30	18.08	19.89
07-00530-15200		20	2.5	3	2.85	12°	6	70	11,000	21.16	22.04	23.00	24.06	26.53
07-00530-15250		25	2.5	3	2.85	12°	6	70	11,000	26.37	27.48	28.70	30.04	Free
07-00530-15300		30	2.5	3	2.85	12°	6	70	12,000	31.58	32.93	34.40	36.03	Free
07-00530-20100	R2	10	3	4	3.8	12°	6	60	9,500	10.83	11.22	11.66	12.14	13.25
07-00530-20120		12	3	4	3.8	12°	6	60	9,500	12.91	13.40	13.94	14.53	15.91
07-00530-20150		15	3	4	3.8	12°	6	60	9,500	16.04	16.67	17.36	18.12	19.89
07-00530-20200		20	3	4	3.8	12°	6	60	11,300	21.26	22.12	23.06	24.10	Free
07-00530-20250		25	3	4	3.8	12°	6	70	12,000	26.47	27.57	28.77	30.09	Free
07-00530-20300		30	3	4	3.8	12°	6	70	12,500	31.68	33.01	34.47	Free	Free
07-00530-20400		40	3	4	3.8	12°	6	80	13,500	42.11	43.91	Free	Free	Free
07-00530-30200	R3	20	6	6	5.7	-	6	70	12,500	Free	Free	Free	Free	Free
07-00530-30250		25	6	6	5.7	-	6	70	12,700	Free	Free	Free	Free	Free
07-00530-30300		30	6	6	5.7	-	6	80	13,100	Free	Free	Free	Free	Free
07-00530-30400		40	6	6	5.7	-	6	80	14,000	Free	Free	Free	Free	Free
07-00530-30500		50	6	6	5.7	-	6	100	15,200	Free	Free	Free	Free	Free