

铜电极加工用长颈平底铣刀  
Long Neck Square End Mill for Copper Electrode

共 74 种规格  
Total 74 sizes

针对铜电极加工特别研发的长颈平底铣刀，  
锋利的刃口能有效抑制毛刺，实现良好的加工面

Long neck square end mill specialized for machining copper alloy.  
Sharpe cutting edge makes less burr and high quality surface.

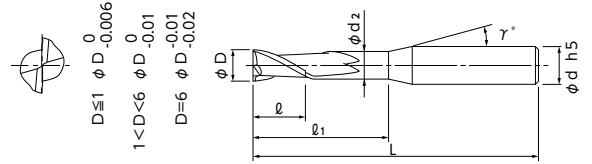
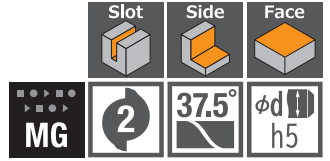

- 针对铜电极加工特别研发的长颈平底铣刀。
- 采用【37.5°】螺旋角，可在抑制加工横线痕产生的同时，实现高切削力和高精度加工品质。
- 采用最优化的刀刃形状与全新 DLC 涂层，实现了长时间高品质的安定加工。
- 也可有效加工钨铜电极。
- Long neck square end mill specialized for machining copper electrode.
- Helix angle 37.5 degrees to achieve both sharpness and finished surface quality that prevents scratches on cutting surface.
- High quality and stable milling performance with long tool life by optimized design and DLC COATING.
- Machining copper tungsten electrodes is also effective.

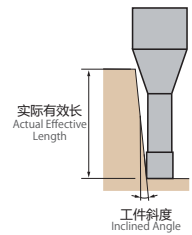

加工材料 Work material

铜 Copper	钨铜 Copper tungsten
◎	◎

单位 [尺寸 : mm / 价格 : 日元]  
Unit [Size : mm / Retail price : JPY]

产品代码 Code No.	(D) 刃径 Dia.	(L1) 颈长 Under neck length	(L) 刃长 Length of cut	(d2) 颈径 Neck Dia.	(γ) 颈角 Neck taper angle	(d) 柄径 Shank Dia.	(L) 全长 Overall length	标准价格 Retail price	相对于工件斜度的有效长 Actual effective length depending on inclined angle of workpiece.				
									30°	1°	1° 30'	2°	3°
07-00100-01003	0.1	0.3	0.2	0.085	12°	4	45	12,700	0.34	0.36	0.38	0.40	0.44
07-00100-01005		0.5	0.2	0.085	12°	4	45	13,300	0.55	0.58	0.61	0.64	0.71
07-00100-01007		0.75	0.2	0.085	12°	4	45	14,000	0.81	0.85	0.89	0.93	1.04
07-00100-01010		1	0.2	0.085	12°	4	45	14,800	1.07	1.12	1.18	1.23	1.37
07-00100-02005	0.2	0.5	0.4	0.18	12°	4	45	9,500	0.57	0.59	0.62	0.65	0.72
07-00100-02010		1	0.4	0.18	12°	4	45	10,000	1.09	1.14	1.19	1.25	1.38
07-00100-02015		1.5	0.4	0.18	12°	4	45	10,500	1.61	1.68	1.76	1.85	2.05
07-00100-02020		2	0.4	0.18	12°	4	45	11,000	2.13	2.23	2.33	2.44	2.71
07-00100-03010	0.3	1	0.6	0.28	12°	4	45	10,000	1.09	1.14	1.19	1.25	1.38
07-00100-03015		1.5	0.6	0.28	12°	4	45	10,500	1.61	1.68	1.76	1.85	2.05
07-00100-03020		2	0.6	0.28	12°	4	45	11,000	2.13	2.23	2.33	2.44	2.71
07-00100-03030		3	0.6	0.28	12°	4	45	11,600	3.17	3.31	3.47	3.64	4.04
07-00100-04010	0.4	1	0.8	0.37	12°	4	45	8,700	1.11	1.16	1.22	1.28	1.42
07-00100-04020		2	0.8	0.37	12°	4	45	8,900	2.15	2.25	2.36	2.47	2.74
07-00100-04030		3	0.8	0.37	12°	4	45	9,100	3.20	3.34	3.50	3.67	4.07
07-00100-04040		4	0.8	0.37	12°	4	45	9,300	4.24	4.43	4.64	4.87	5.40
07-00100-05015	0.5	1.5	1	0.46	12°	4	45	8,500	1.66	1.73	1.81	1.90	2.11
07-00100-05020		2	1	0.46	12°	4	45	8,700	2.18	2.28	2.38	2.50	2.77
07-00100-05030		3	1	0.46	12°	4	45	8,900	3.22	3.37	3.52	3.70	4.10
07-00100-05040		4	1	0.46	12°	4	45	9,100	4.26	4.46	4.66	4.89	5.43
07-00100-05060	0.6	6	1	0.46	12°	4	45	9,400	6.35	6.63	6.95	7.29	8.08
07-00100-06020		2	1.2	0.56	12°	4	45	9,400	2.18	2.28	2.38	2.50	2.77
07-00100-06030		3	1.2	0.56	12°	4	45	9,600	3.22	3.37	3.52	3.70	4.10
07-00100-06040		4	1.2	0.56	12°	4	45	9,800	4.26	4.46	4.66	4.89	5.43
07-00100-06060	6	1.2	0.56	12°	4	45	10,100	6.35	6.63	6.95	7.29	8.08	

订购方式

请指定DHR237 刃径(D) × 颈长(L1)  
When you order, indicate DHR237 (D) × (L1).

※(γ)为参考值。  
※(γ) is reference value.

产品代码 Code No.	(D) 刃径 Dia.	(d <sub>1</sub> ) 颈长 Under neck length	(ℓ) 刃长 Length of cut	(d <sub>2</sub> ) 颈径 Neck Dia.	(γ) 颈角 Neck taper angle	(d) 柄径 Shank Dia.	(L) 全长 Overall length	标准价格 Retail price	相对于工件斜度的有效长 Actual effective length depending on inclined angle of workpiece.				
									30°	1°	1° 30′	2°	3°
07-00100-08030	0.8	3	1.6	0.76	12°	4	45	9,600	3.22	3.37	3.52	3.70	4.10
07-00100-08040		4	1.6	0.76	12°	4	45	9,800	4.26	4.46	4.66	4.89	5.43
07-00100-08060		6	1.6	0.76	12°	4	45	10,100	6.35	6.63	6.95	7.29	8.08
07-00100-08080		8	1.6	0.76	12°	4	50	10,300	8.44	8.81	9.23	9.68	10.74
07-00100-10030	1	3	2	0.95	12°	4	45	9,100	3.25	3.39	3.55	3.73	4.13
07-00100-10040		4	2	0.95	12°	4	45	9,200	4.29	4.48	4.69	4.92	5.46
07-00100-10050		5	2	0.95	12°	4	45	9,400	5.33	5.57	5.83	6.12	6.79
07-00100-10060		6	2	0.95	12°	4	45	9,600	6.37	6.66	6.97	7.32	8.11
07-00100-10080		8	2	0.95	12°	4	50	9,800	8.46	8.84	9.25	9.71	10.77
07-00100-10100		10	2	0.95	12°	4	50	10,000	10.55	11.02	11.53	12.10	13.42
07-00100-10120	12	2	0.95	12°	4	50	10,000	12.63	13.20	13.82	14.49	16.08	
07-00100-15040	1.5	4	3	1.45	12°	4	45	9,400	4.29	4.48	4.69	4.92	5.46
07-00100-15060		6	3	1.45	12°	4	50	9,400	6.37	6.66	6.97	7.32	8.11
07-00100-15080		8	3	1.45	12°	4	50	9,600	8.46	8.84	9.25	9.71	10.77
07-00100-15100		10	3	1.45	12°	4	50	9,900	10.55	11.02	11.53	12.10	13.42
07-00100-15120		12	3	1.45	12°	4	50	9,900	12.63	13.20	13.82	14.49	16.08
07-00100-15160		16	3	1.45	12°	4	60	10,200	16.80	17.55	18.38	19.28	21.39
07-00100-20060	2	6	4	1.94	12°	4	50	9,200	6.40	6.69	7.00	7.34	8.15
07-00100-20080		8	4	1.94	12°	4	50	9,200	8.48	8.86	9.28	9.74	10.80
07-00100-20100		10	4	1.94	12°	4	50	9,300	10.57	11.04	11.56	12.13	13.45
07-00100-20120		12	4	1.94	12°	4	50	9,300	12.66	13.22	13.84	14.52	16.11
07-00100-20140		14	4	1.94	12°	4	50	9,300	14.74	15.40	16.12	16.92	18.76
07-00100-20160		16	4	1.94	12°	4	60	9,500	16.83	17.58	18.40	19.31	Free
07-00100-20200	20	4	1.94	12°	4	60	9,500	21.00	21.94	22.97	24.10	Free	
07-00100-25060	2.5	6	5	2.4	12°	4	45	9,400	6.50	6.79	7.11	7.46	8.27
07-00100-25080		8	5	2.4	12°	4	50	9,400	8.58	8.97	9.39	9.85	10.93
07-00100-25100		10	5	2.4	12°	4	50	9,600	10.67	11.15	11.67	12.24	13.58
07-00100-25120		12	5	2.4	12°	4	50	10,000	12.75	13.32	13.95	14.64	Free
07-00100-25140		14	5	2.4	12°	4	50	10,000	14.84	15.50	16.23	17.03	Free
07-00100-25160		16	5	2.4	12°	4	50	10,200	16.93	17.68	18.51	19.42	Free
07-00100-25200	20	5	2.4	12°	4	60	10,800	21.10	22.04	23.07	Free	Free	
07-00100-30080	3	8	6	2.85	12°	6	50	9,500	8.71	9.10	9.52	9.99	11.08
07-00100-30100		10	6	2.85	12°	6	50	9,700	10.79	11.27	11.80	12.38	13.74
07-00100-30150		15	6	2.85	12°	6	60	10,100	16.01	16.72	17.50	18.37	20.37
07-00100-30200		20	6	2.85	12°	6	60	10,500	21.22	22.17	23.21	24.35	27.01
07-00100-30250		25	6	2.85	12°	6	70	11,500	26.43	27.62	28.91	30.33	Free
07-00100-40100	4	10	8	3.8	12°	6	50	8,800	10.91	11.40	11.94	12.52	13.89
07-00100-40150		15	8	3.8	12°	6	60	9,000	16.13	16.85	17.64	18.51	Free
07-00100-40200		20	8	3.8	12°	6	60	9,600	21.34	22.30	23.34	24.49	Free
07-00100-40250		25	8	3.8	12°	6	70	10,700	26.56	27.74	29.04	Free	Free
07-00100-40300		30	8	3.8	12°	6	70	11,100	31.77	33.19	34.75	Free	Free
07-00100-50150	5	15	10	4.8	12°	6	50	9,000	16.13	16.85	17.64	Free	Free
07-00100-50200		20	10	4.8	12°	6	60	9,600	21.34	22.30	Free	Free	Free
07-00100-50250		25	10	4.8	12°	6	60	10,700	26.56	27.74	Free	Free	Free
07-00100-50300		30	10	4.8	12°	6	70	11,100	31.77	Free	Free	Free	Free
07-00100-60150	6	15	12	5.8	-	6	50	9,600	Free	Free	Free	Free	Free
07-00100-60200		20	12	5.8	-	6	60	11,000	Free	Free	Free	Free	Free
07-00100-60300		30	12	5.8	-	6	70	12,000	Free	Free	Free	Free	Free
07-00100-60500		50	12	5.8	-	6	90	18,000	Free	Free	Free	Free	Free